



How Do Our Maps Work?

- Feature – One mapped object that carries information with it in a data table. A good example is a parcel you that click to show tax ownership information.

How Do Our Maps Work?

- Feature – One mapped object that carries information with it in a data table. A good example is a parcel you that click to show tax ownership information.
- Feature Class – A group of features together in one map layer.

How Do Our Maps Work?

- Feature – One mapped object that carries information with it in a data table. A good example is a parcel you that click to show tax ownership information.
- Feature Class – A group of features together in one map layer.
- Maps are a grouping of different feature classes used to paint the big picture.

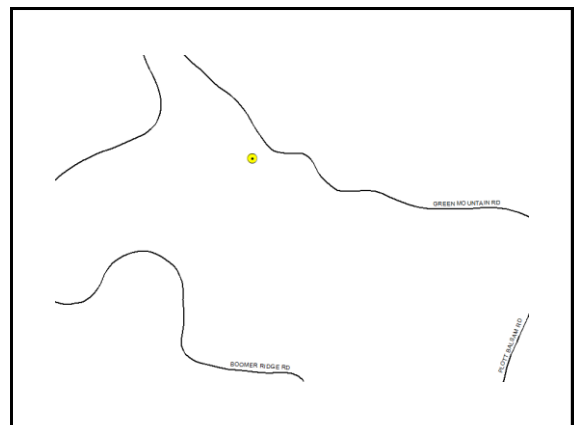
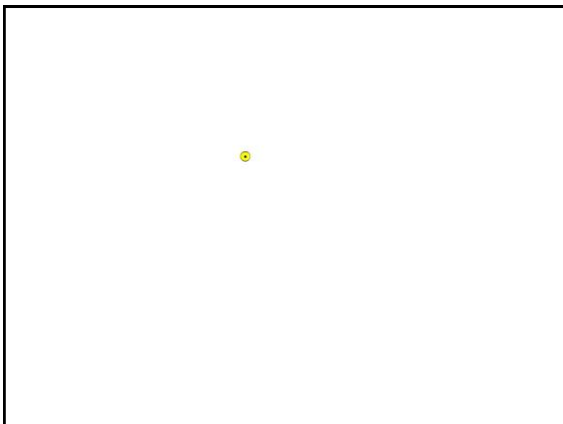

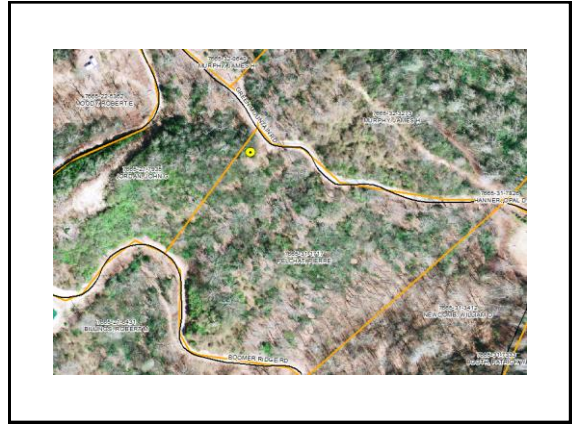
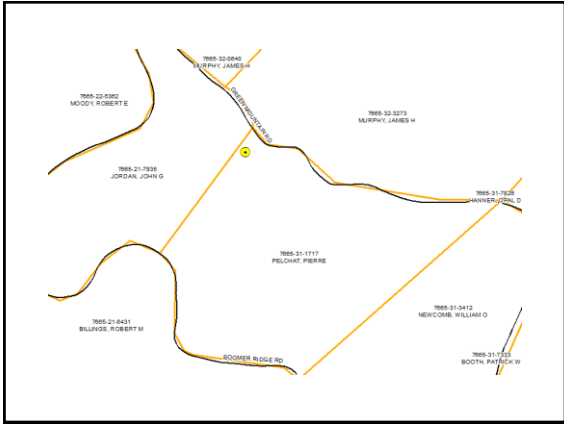

Maps Should Be Free Range



Maps Should Be Free Range

- Electronic maps are trapped inside the buildings with GIS servers.



Justice Center



Justice Center



Health Department

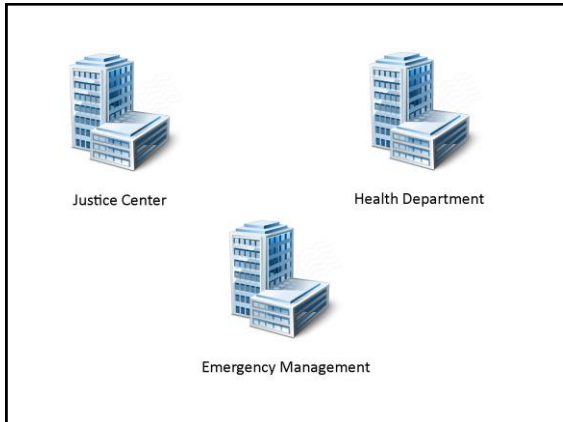

Maps Should Be Free Range

- Electronic maps are trapped inside the buildings with GIS servers.
- This limits how maps can be used in many situations.

Maps Should Be Free Range

- Electronic maps are trapped inside the buildings with GIS servers.
- This limits how maps can be used in many situations.
- Internet based maps could be used for public notification.

Maps Should Be Free Range

- Electronic maps are trapped inside the buildings with GIS servers.
- This limits how maps can be used in many situations.
- Internet based maps could be used for public notification.
- Internet maps could also be used for field work.

Map Services

- Map Service – An internet based version of a feature class.

Map Services

- Map Service – An internet based version of a feature class.
- Allows feature classes to be used at offsite facilities and in the field.

Map Services

- Map Service – An internet based version of a feature class.
- Allows feature classes to be used at offsite facilities and in the field.
- Hosted by the County GIS Department and available by secured login.

Map Services

- Map Service – An internet based version of a feature class.
- Allows feature classes to be used at offsite facilities and in the field.
- Hosted by the County GIS Department and available by secured login.
- Can be used in internet based maps for incident command, field inspectors, and law enforcement.

Aerial Photography

- Biggest storage challenge. Exponentially bigger in size than all other map information.

Aerial Photography

- Two types of aerial photography:
 - Orthophotography – Aerial photography seen on the county website and used for mapping. Makes the earth look flat.
 - Pictometry – Allows the user to see the sides of structures. Commissioner Deitz and Congressman Heath Shuler are responsible for funding Jackson County's first Pictometry.

Orthophotography



Pictometry



How Do We Make Aerial Photography Available Over the Internet?

- Orthophotography – Available through the State of North Carolina over the internet as a map service free of charge.

How Do We Make Aerial Photography Available Over the Internet?

- Orthophotography – Available through the State of North Carolina over the internet as a map service free of charge.
- Pictometry –
 - Impossible to put on the internet from our facilities.
 - Needs to be accessed through a subscription.
 - Currently unavailable to law enforcement.