

SPECIFICATIONS PACKAGE

JACKSON COUNTY SPLASH PAD

- BID PACKAGE SUBMITTAL-

2024

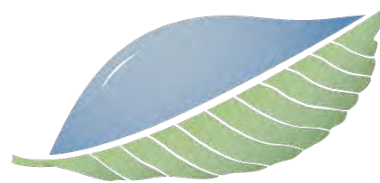

EQUINOX

EQUINOX ENVIRONMENTAL CONSULTATION AND DESIGN, INC.

14 O'Henry Ave, Suite 206, Asheville NC 28801

828.253.6856

www.equinoxenvironmental.com

SPECIFICATIONS

TABLE OF CONTENTS

SITE ELEMENTS

Page 1.....	Bike Rack: Anova Vibe Series, Textured Fern (or equal)
Page 2... ..	Bench: Anova Vibe Series 5 ½', Recycled Plastic & Textured Fern (or equal)
Page 3.....	Waste Receptacle: Anova Vibe Series 45 Gallon, Recycled Plastic & Textured Fern (or equal)
Page 4.....	Water Fountain: 10145 SMSSFA, Black (or equal)
Page 5.....	Picnic Table: Jamestown 6' Universal Access Picnic Table (or equal)
Page 6.....	Tennis: 10-S AL1014 Tournament Net & DL5000-blk Post Set, VCP Windscreen 9' Open Mesh (or equal)
Page 7,8.....	Pickleball: 10-S AP5000 Pickleball Net, PBPSTAL100-blk Post Set, AP5055 Net Strap, (or equal)
Page 9-20.....	Basketball: Silverback Sports Model B5402W + B5402F Goal (or equal)
Appendix 1:	Pavilion: Cedar Forest Products 28x44, Open Timber Truss (or equal)
Appendix 2:	Restroom: ROMTEC Model 2043 (or equal)
Appendix 3:	Splash Pad Products: Aquatix by Landscape Structures (or equal)
Appendix 4:	Playground: Landscape Structures (or equal)

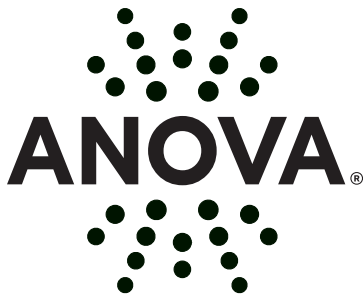

Contact Us:
800.231.1327
specify@anovafurnishings.com

RLA30 - Vibe Bike Rack

Unibody powder-coated steel bike rack.

Material

The bike rack stands 30.94" tall, 27.08" deep, and is made from 10-gauge steel cut to a 4" width. The bike rack is designed to be used in groups or as a stand-alone product.

The unibody bike rack **must be surface mounted** to the ground with two pre-drilled .40" mounting holes on the bottom stretch of the bike rack. **Surface mounting hardware is included.**

Finish

Fade-resistant, powder coated steel features a state-of-the-art primer proven to prevent rusting. Treated components exceed the industry standard by 34% in testing by independent sources.

Color

See website or sales representative for color choices.

Assembly

The bike rack ships fully assembled. Some assembly required for installation; mounting hardware is included.

Maintenance

The product is virtually maintenance-free and requires only periodic cleaning with a sponge and a solution of mild detergent and water to remove surface dirt. **Do not clean with solvent or petroleum base products.**

Warranty

20-year limited structural warranty with 3-year finish warranty from the date of purchase. See full details on multi-year warranties for components at www.anovafurnishings.com/warranty.aspx.

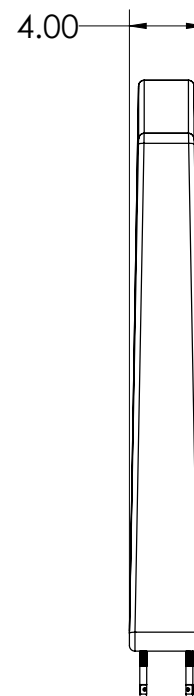
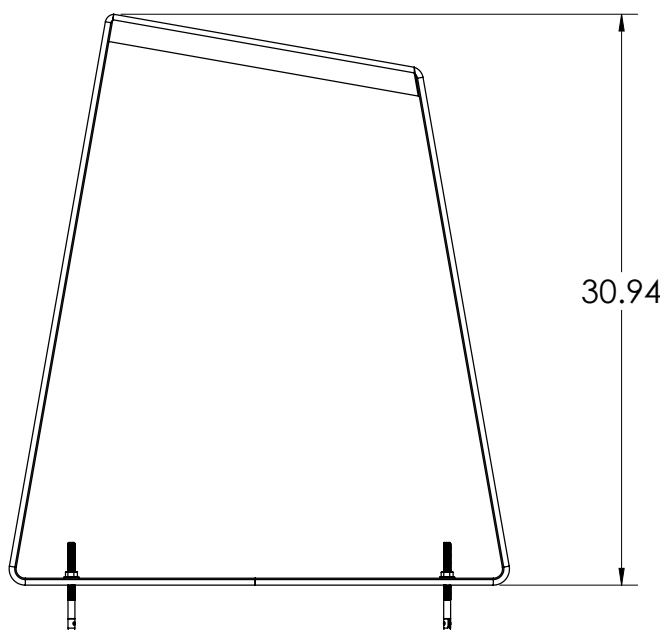



Contact Us:
 Phone Number: 800.231.1327
 Email: specify@anovafurnishings.com

RLA90R - Vibe 5 1/2' Recycled Plastic Flat Bench

5 1/2' flat bench with recycled plastic planks and aluminum legs and frame.

Material

The Vibe 5 1/2' flat bench is composed of 5.0" x .75" recycled plastic planks and 2" wide, 5052 aluminum alloy legs and frame. The bench is 65.75" long and will support 200 lbs. per linear foot.

The bench is designed to be portable for flexibility in placement or surface mounted using two pre-drilled countersunk holes at the base at either end of the bench. **Optional hold down kit sold separately.** The bench also comes with factory installed plastic glides on each leg base to avoid damage to mounting surface or powder coating on the product.

The planks are made of 95% recycled content by weight and are impervious to moisture and corrosion, do not require the application of sealants or preservatives, and will never need painting or staining.

Finish

Rust-proof aluminum features a fade-resistant powder coating. Treated components exceed the industry standard by 34% in testing by independent sources.

Color

See website or sales representative for color choices.

Assembly

The bench ships fully assembled. Optional hold down kit requires some assembly, if purchased.

Maintenance

The product is virtually maintenance-free and requires only periodic cleaning with a sponge and a solution of mild detergent and water to remove surface dirt. **Do not clean with solvent or petroleum base products.**

Warranty

20-year limited structural warranty, 20-year recycled plastic warranty, and 3-year frame finish warranty from the date of purchase. See full details on multi-year warranties for components at www.anovafurnishings.com/warranty.aspx.



Accessories

Hold Down Kit

A1037

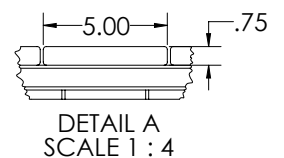
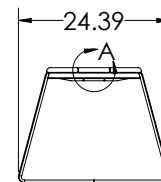
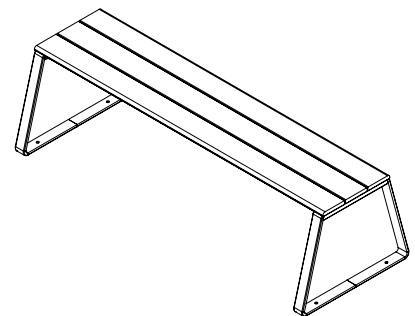
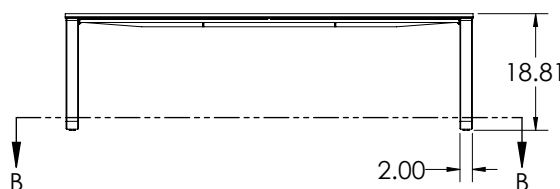
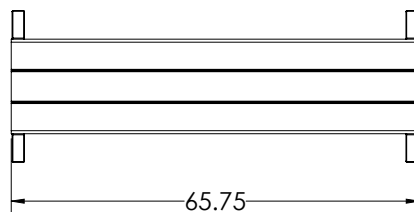
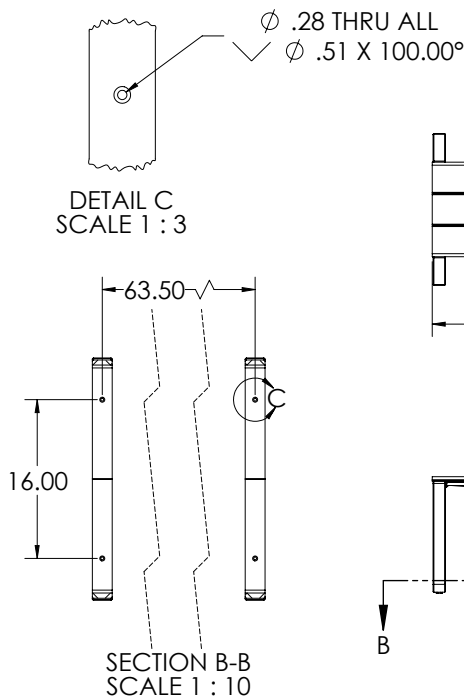



Contact Us:
 Phone Number: 800.231.1327
 Email: specify@anovafurnishings.com

RLA45R - Vibe 45 Gallon Recycled Plastic Trash Receptacle with Bonnet Top

45-gallon aluminum trash receptacle with recycled plastic planks, built-in bonnet top, reusable plastic liner and plastic glides.

Material

The receptacle is 48.49" at its tallest point and 30.00" wide by 23.50" deep. The receptacle is composed of 4.75" x .75" recycled plastic planks with 3" wide, 5052 aluminum alloy legs and frame and features a built-in bonnet top. The side door of the receptacle features a continuous geared hinge and a tamper-resistant cam lock and key system.

Each receptacle leg has two pre-drilled holes for optional surface mounting and comes with factory installed plastic glides to avoid damage to mounting surface or powder coating on the product. The reusable plastic liner is made of high-density polyethylene. **Optional hold down kit sold separately.**

The planks are made of 95% recycled content by weight and are impervious to moisture and corrosion, do not require the application of sealants or preservatives, and will never need painting or staining

Finish

Rust-proof aluminum features a fade-resistant powder coating. Treated components exceed the industry standard by 34% in testing by independent sources.

Color

See website or sales representative for color choices.

Assembly

The receptacle ships fully assembled. Optional hold down kit requires some assembly, if purchased.

Maintenance

The product is virtually maintenance-free and requires only periodic cleaning with a sponge and a solution of mild detergent and water to remove surface dirt. **Do not clean with solvent or petroleum base products.**

Warranty

20-year limited structural warranty, 20-year recycled plastic warranty and 3-year frame finish warranty from the date of purchase. See full details on multi-year warranties for components at www.anovafurnishings.com/warranty.aspx.

Accessories

Hold Down Kit

A1037

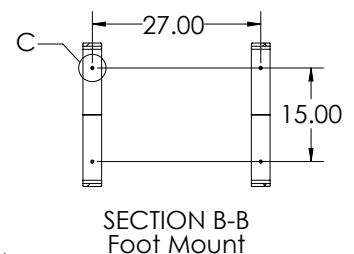
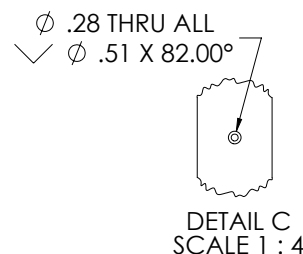
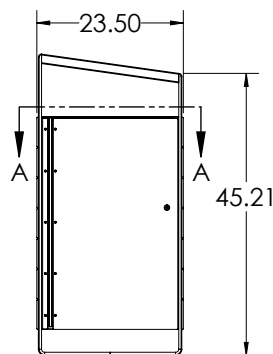
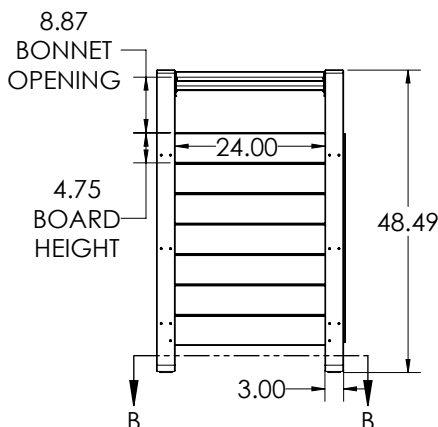
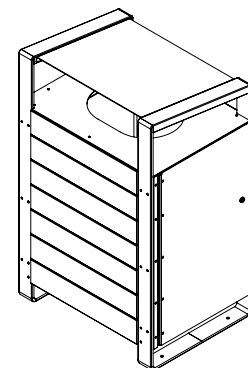
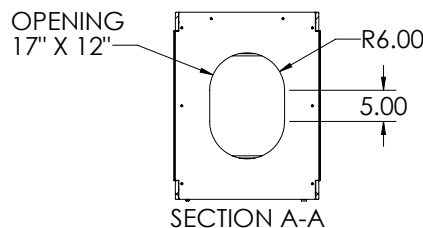
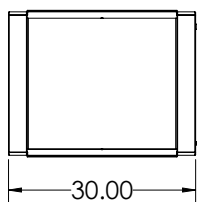

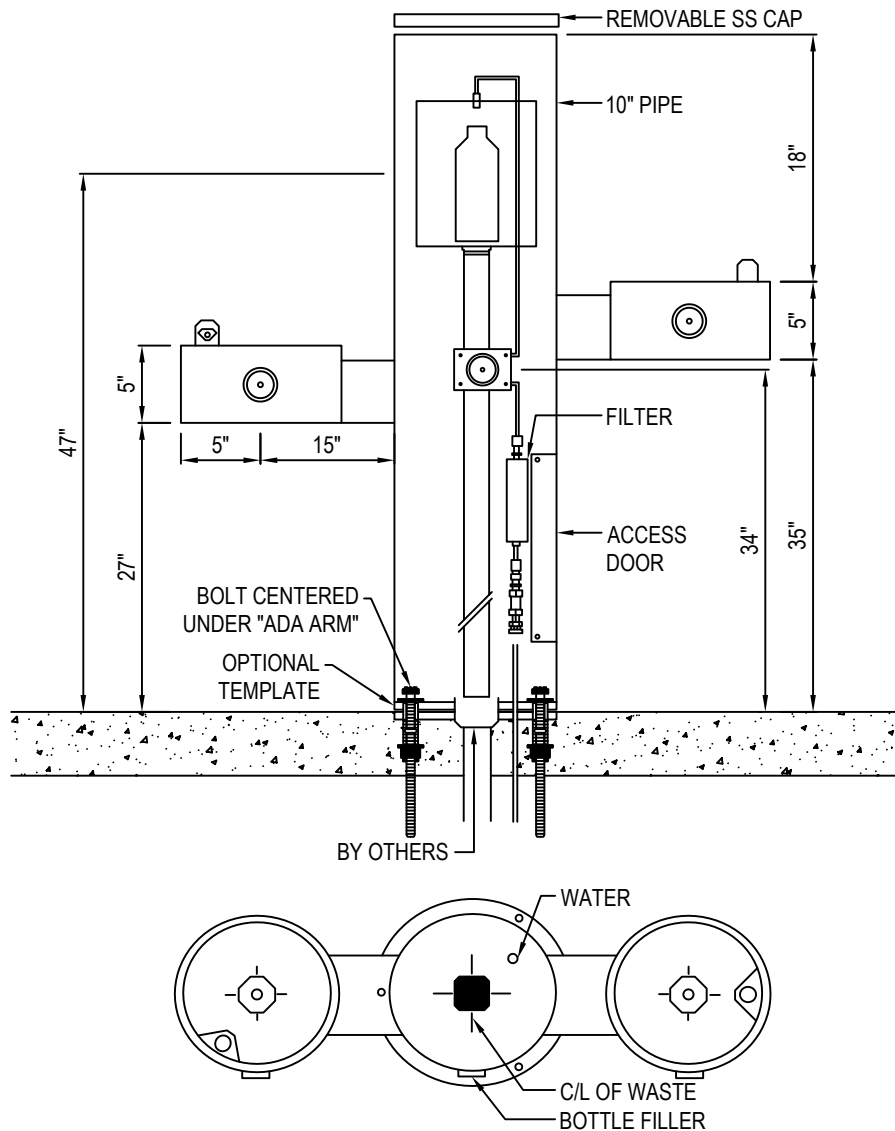

NOTES:

1. INSTALLATION TO BE COMPLETED IN ACCORDANCE WITH MANUFACTURER'S SPECIFICATIONS.
2. DO NOT SCALE DRAWING.
3. THIS DRAWING IS INTENDED FOR USE BY ARCHITECTS, ENGINEERS, CONTRACTORS, CONSULTANTS AND DESIGN PROFESSIONALS FOR PLANNING PURPOSES ONLY. THIS DRAWING MAY NOT BE USED FOR CONSTRUCTION.
4. ALL INFORMATION CONTAINED HEREIN WAS CURRENT AT THE TIME OF DEVELOPMENT BUT MUST BE REVIEWED AND APPROVED BY THE PRODUCT MANUFACTURER TO BE CONSIDERED ACCURATE.
5. CONTRACTOR'S NOTE: FOR PRODUCT AND COMPANY INFORMATION VISIT www.CADdetails.com/info AND ENTER REFERENCE NUMBER 3354-17.45.

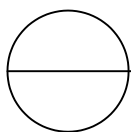

MODEL 10145SMFA

10145SM SHOWN WITH OPTIONAL 10" SS SURFACE CARRIER



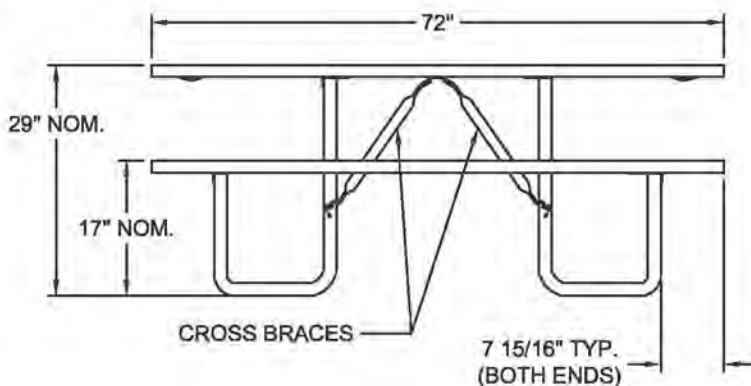
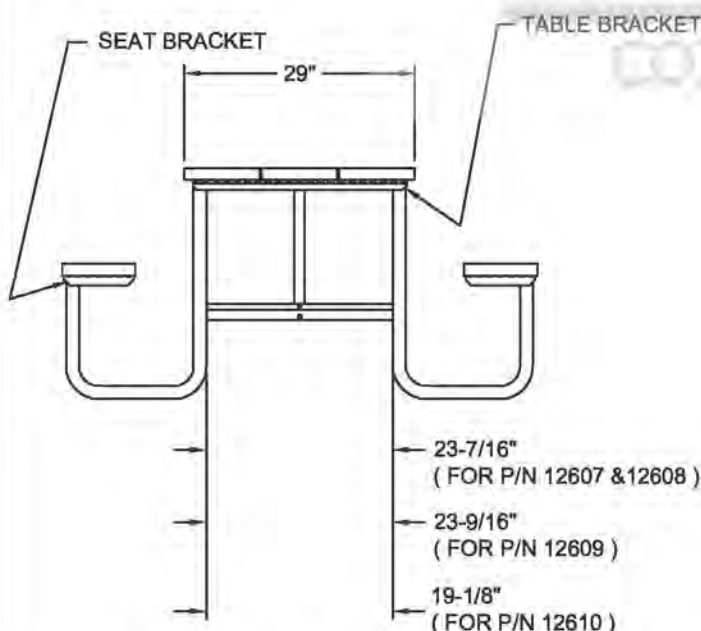
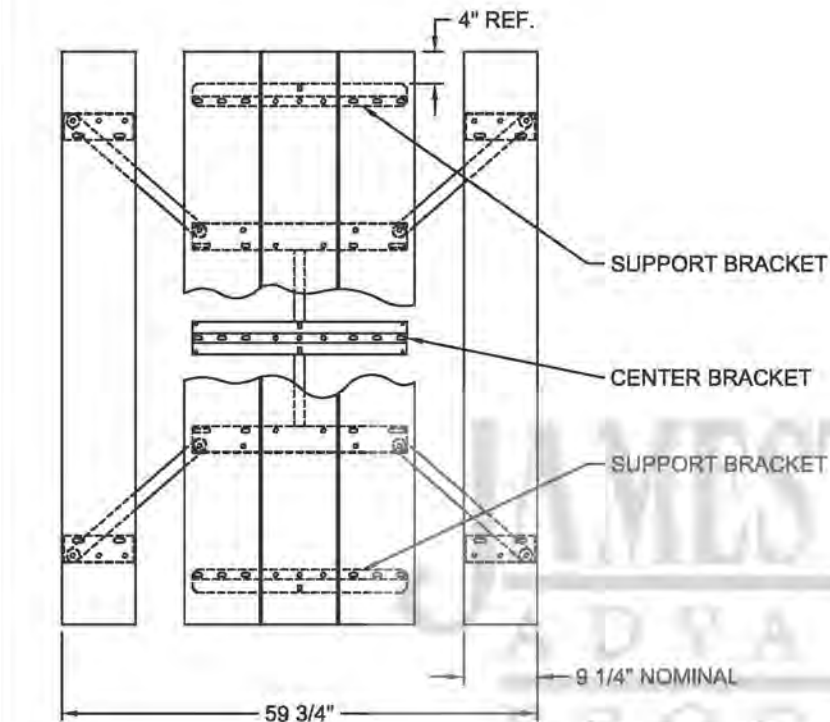

- Wheelchair accessibility at both ends.
- Seats are the same length as the table top, thus a benefit over the extended top design.
- Meets or exceeds current ADA guidelines for wheelchair access to picnic tables.
- The one-piece welded construction frames are fabricated using continuous MIG welds for strength.
- All pipe and tubing conform to ASTM A513-94, and all steel components conform to ASTM-A569.
- All cross braces are 1" schedule 40 pipe (.133" thk. wall).
- Center brackets are all 1/8" thk. (12 ga.) steel. Table and seat brackets are 1/8" thk. (12 ga.) steel for P/N's 12607, 12608 and 12609, and 3/16" thk. (7 ga.) steel for P/N 12610.
- Support brackets are 1/8" thk. (12 ga.) steel.
- Assembly fasteners are 3/8" dia. galvanized steel carriage bolts.
- Optional lumber is predrilled and has 3/8" radius rounded corners.
- All exposed corners are chamfered for safety.
- Approximate weights of tables less lumber:
P/N 12607 = 80 lbs
P/N 12608 = 65 lbs
P/N 12609 = 55 lbs
P/N 12610 = 100 lbs

CUSTOMER APPROVAL :

DATE :

JAMESTOWN
ADVANCED
PRODUCTS
CORPORATION

THIS DRAWING, WHICH CONTAINS PROPRIETARY INFORMATION, IS THE PROPERTY OF JAMESTOWN ADVANCED PRODUCTS CORPORATION. IT SHALL NOT BE REPRODUCED IN ANY MANNER NOR DISCLOSED TO THIRD PARTIES WITHOUT WRITTEN PERMISSION OF JAMESTOWN ADVANCED PRODUCTS CORPORATION.

PRODUCT PART NUMBER : 12607, 08, 09 & 10
(-1 THRU -6)

PRODUCT DESCRIPTION :
6' UNIVERSAL ACCESS PICNIC TABLE

DATE : 09-08-06

REV. NO. 1

2855 GIRTS ROAD
JAMESTOWN, NY 14701

PHONE 800-452-0639 -- FAX 716-483-5398 -- WWW.JAMESTOWNADVANCED.COM

Tennis Court Accessories:

Note, the accessories below are to be installed per manufacturare guidleines. A dditional items may be required for installation and function, with approval of landscape architect/owner.



Home > 10-S Tournament Net



10-S Tournament Net

Product code: AL1014

USD \$164.00

Quantity	Price
1 - 3	\$164.00
4 +	\$159.00

Description

The 10-S Tournament Net is a fantastic, mid-tier net. The 10-S Tournament Net features 4 rows of lock stitch, UV treated threading, a 36 ounce vinyl headband and 3.5mm polyethylene net body. The 10-S Tournament also includes a free center strap and 3 year pro-rated warranty. The 10-S Tournament Net is very popular net with our multi-family housing and municipal customers.

Qty:

ADD TO CART

Add to Wishlist

Home > 10-S NeverRust Tennis Post Set Aluminum



10-S NeverRust Tennis Post Set Aluminum

Product code: DL5000-BLK

USD \$359.00

Description

A High quality aluminum external wind post set with Galvanized lacing rods. These posts are Light, Rust Proof and strong. Reinforced inside allows for lighter aluminum post but extremely durable post. Flattened ends for ease of installation and removal. 2 7/8"OD aluminum external wind post. Perfect for salty coastal climates, clay courts or anywhere high humidity and rust may be a problem. Colors: Green & Black * These posts are also ideal for easy removal as the lightest quality post on the market * Total Length = 56" Stop Collar at 42" for correct height

Color

Qty:

ADD TO CART

Add to Wishlist

Home > VCP Windscreen 9' Open Mesh



VCP Windscreen 9' Open Mesh

Product code: EV1009

USD \$7.85

Description

Standard VCP Tennis Windscreen is an economical custom tennis windscreen option. Standard VCP is constructed from 8 oz. vinyl coated polyester and features lock stitching for added durability. Grommets are included every 12" for ease of installation. Standard VCP is available in Black, Dark Green, Royal Blue, custom cut to your specifications and has a 70% Shade Factor. High quality logo imprinting is available. Please contact our customer service representatives at 954-969-5440 with the length of each piece you need and we will provide you with a free written estimate for your facility.

* When ordering custom windscreen please send us your screen details & sizes. The link below will guide you to a printable "10-S Windscreen Order Form". Please email sales@10-s.com or fax this form back to receive an approval estimate based on your specifications. *

Link to windscreen order form: <http://www.10-s.com/site/tennis-supply/10-S-Tennis-Supply-Windscreen-Order-Form.pdf>

Link to How to measure for custom windscreen form: <http://vimeo.com/89532672>

Link to How to install custom windscreen form: <http://vimeo.com/89512343>

Color

Qty:

ADD TO CART

Add to Wishlist

Pickleball Court Accessories:

Note, the accessories below are to be installed per manufacturare guidleines. A dditional items may be required for installation and function, with approval of landscape architect/owner.



10-S Sports / Pickleball Net

SKU: AP5000
\$110.00

Quantity

ADD TO CART

ADD TO WISHLIST

Share: [Twitter](#) [Facebook](#)

DESCRIPTION

This is a top quality 3mm net, manufactured to 10-S high performance standards! This net is perfect for Pickleball, Masters Tennis and 10 & Under Tennis. Sized at 21' 9" x 36" to fit



10-S NeverRust Pickleball Post Set 2 7/8"

COLOR:

SKU: PBPSTAL100-Blk
\$345.00

Quantity

ADD TO CART

ADD TO WISHLIST

Share: [Twitter](#) [Facebook](#)

DESCRIPTION

A High quality aluminum external wind pickleball post set. These posts are Light, Rust Proof and strong. Reinforced inside allows for lighter aluminum post but extremely durable post. Flattened ends for ease of installation and removal. 2 7/8"OD aluminum external wind post. Perfect for salty coastal climates, clay courts or anywhere high humidity and rust may be a problem. * Posts are approximately 50" Long with stop collar to hold net at Pickleball height / 36" * These posts are also ideal for easy removal as the lightest quality post on the market *

Pickleball Court Accessories:

Note, the accessories below are to be installed per manufacture guidelines. A
 dditional items may be required for installation and function, with approval of landscape architect/owner.

[Home](#) > [VCP Windscreen 6' Open Mesh](#)



VCP Windscreen 6' Open Mesh

Product code: EV1006

USD \$4.95

Color - Select -

Qty: 1

ADD TO CART

Description

[Add to Wishlist](#)

Standard VCP Tennis Windscreen is an economical custom tennis windscreen option. Standard VCP is constructed from 8 oz. vinyl coated polyester and features lock stitching for added durability. Grommets are included every 12" for ease of installation. Standard VCP is available in Black, Dark Green, Royal Blue, custom cut to your specifications and has a 70% Shade Factor. High quality logo imprinting is available. Please contact our customer service representatives at 954-969-5440 with the length of each piece you need and we will provide you with a free written estimate for your facility.

* When ordering custom windscreen please send us your screen details & sizes. The link below will guide you to a printable "10-S Windscreen Order Form". Please email sales@10-s.com or fax this form back to receive an approval estimate based on your specifications. *

Link to windscreen order form: <http://www.10-s.com/site/tennis-supply/10-S-Tennis-Supply-Windscreen-Order-Form.pdf>

Link to How to measure for custom windscreen form: <http://vimeo.com/89532672>

Link to How to install custom windscreen form: <http://vimeo.com/89512343>



MODEL NO.

B5402W

B5402F

SB60

BASKETBALL SYSTEM

OWNER'S MANUAL

1. **Read this manual carefully before starting assembly.** Read each step completely before beginning each step.
2. **Some smaller parts may be shipped inside larger parts. Check inside all parts and cartons before assembling or ordering parts.**
3. **To make assembly of your basketball system easier, use the Hardware Identifier on page 3 to identify and sort all fasteners. Check all cartons for kits. All hardware is not located in one kit.**
4. **Do not tighten hardware until instructed to do so.** If hardware is tightened too soon, mounting holes may not align and parts may not easily fit together. Leave locknuts slightly loose until you are instructed to tighten them.
5. **Save this instruction in the event that the manufacturer has to be contacted for replacement parts.**

Please Do Not Return This Product To The Store!

Contact Escalade® Sports customer service department at:

Phone: 1-888-USA-GOAL Toll Free!

Fax: 1-866-873-3536 Toll Free!

E-mail: basketball@escaladesports.com

Mailing Address (correspondence only):

Escalade Sports

PO Box 889

Evansville, IN 47706



Please visit our World Wide Web site at: www.escaladesports.com

ON-LINE TROUBLE SHOOTING

TECHNICAL ASSISTANCE

ON-LINE PARTS REQUESTS

FREQUENTLY ASKED QUESTIONS

ADDITIONAL ESCALADE® SPORTS PRODUCT INFORMATION

ESCALADE®

S P O R T S

2L-7198-00

Escalade® Sports products may be manufactured and/or licensed under the following patents:

6419596, 6179733, 5919102, 5071120, 4798381, 4424968, D326128, 7244046

Additional patents may be pending. One or more of the listed patents and/or pending patents may cover specific product.

©2009 Escalade® Sports



SAFETY INSTRUCTIONS



FAILURE TO FOLLOW THESE WARNINGS MAY RESULT IN SERIOUS INJURY AND/OR PROPERTY DAMAGE.

Owner must ensure that all players know and follow these rules for safe operation of the system.



WARNING

FAILURE TO FOLLOW THESE WARNINGS MAY RESULT IN SERIOUS INJURY AND/OR PROPERTY DAMAGE.

Owner must ensure that all players know and follow these rules for safe operation of the system.

Do not dunk on this unit

Do not hang from any part of the unit, including the backboard, rim, support braces, or net.

Do not slide, climb, or play on pole.

Keep organic material away from pole base. Grass, litter, etc. could cause corrosion and/or deterioration.

Check pole system for signs of corrosion (rust, pitting, chipping). Remove rust and/or loose paint completely and repaint with exterior enamel paint. If rust has penetrated through the steel anywhere, replace pole immediately.

Check system before each use for proper ballast, loose hardware, excessive wear, and signs of corrosion and repair before using.

During play, use extreme caution to keep players face away from the backboard, rim, and net. Serious injury could occur if teeth/face come in contact with backboard, rim, or net.

Wear a mouth guard when playing to avoid dental injuries.

When adjusting height, keep hands and fingers away from moving parts.

During play, do not wear jewelry (rings, watches, necklaces, etc.). Objects may entangle in net.

Do not allow children to adjust system.

Check system before each use for instability.

Never play on damaged equipment.

4L-8109-00



SAFETY INSTRUCTIONS



FAILURE TO FOLLOW THESE SAFETY INSTRUCTIONS MAY RESULT IN SERIOUS INJURY, PROPERTY DAMAGE AND WILL VOID WARRANTY.

Owner must ensure that all players know and follow these rules for safe operation of the system.

To ensure safety, do not attempt to assemble this system without following the instructions carefully. Proper and complete assembly, use and supervision is essential for proper operation and to reduce the risk of accident or injury. A high probability of serious injury exists if this system is not installed, maintained, and operated properly.

- If using a ladder during assembly, use extreme caution.
- 4 people are recommended for this operation.
- Seat the pole sections properly (if applicable). Failure to do so could allow the pole sections to separate during play.
- Before digging contact utility company to locate underground power cables, gas and water lines. Ensure there are no overhead power lines within 20 ft. (7m) radius of pole location.
- Climate, corrosion or misuse could result in system failure.
- If technical assistance is required, contact the manufacturer.
- Minimum operational height is 6'6" (1.98m) to the bottom of backboard.

*Most injuries are caused by misuse and/or not following instructions.
Use caution when using this system.*

WARNING!

**Failure to observe this warning
may cause property damage
and/or serious injury.**

(Affixed to backboard)

This product is NOT designed to support a player hanging from any component of this basketball system.
Rim height adjustments should be made under parental supervision.
Wear a mouth guard when playing to avoid dental injuries.
During play, do not wear jewelry (rings, watches, necklaces, etc).
Objects may entangle in net.

BASKETBALL SYSTEM'S HARDWARE IDENTIFIER

Note: Check all cartons for hardware. All hardware is not packed in one kit.

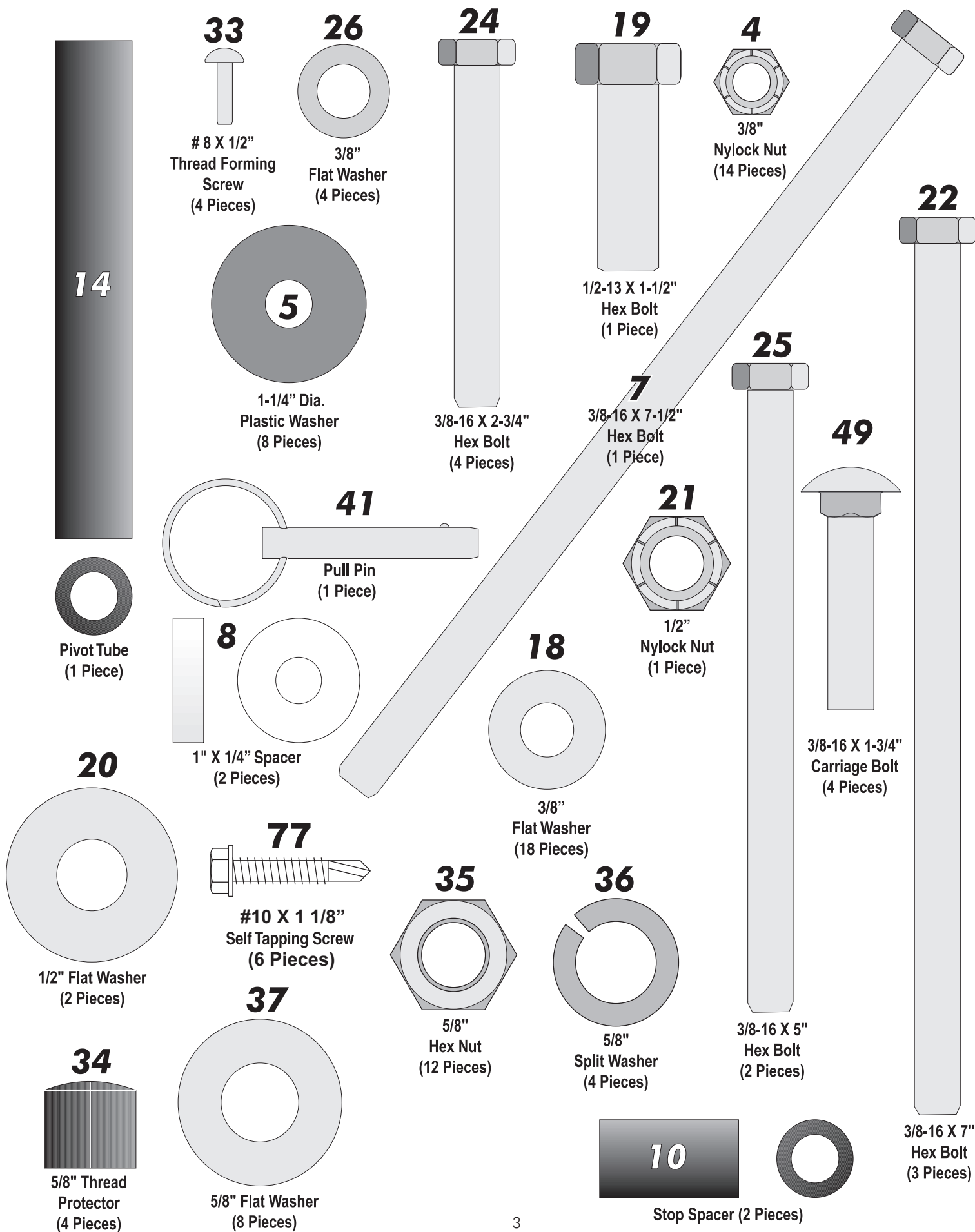

INSTALLATION TIMELINE

1. Prior to anchor system and goal assembly, call utility services for location of underground utility lines before you dig.
2. Vertical main post assembly is a two part process.

PART 1

Day 1. Complete Anchor System Installation Instructions. (Below)

Day 2-4. Allow concrete to cure.

PART 2

Day 5. Complete Silverback® assembly instructions. (Requires four adults)

ANCHOR SYSTEM INSTALLATION INSTRUCTIONS (Day 1)



Before digging hole for anchor system, check for buried power, gas, water, and telecommunication lines! Failure to do so could result in serious or fatal injury! Contact your local utility company if unsure.

Items needed for Anchor Installation (not included)

- | | |
|---|------------------|
| 9 - 80 lb. bags of concrete | 1 - wheel barrow |
| 1 - post hole digger (optional) | 1 - garden hose |
| 1 - 15/16" open end wrench | 1 - level |
| 1 - 15/16" socket and ratchet (optional) | 1 - tape measure |
| 1 - concrete form (see note after step 2) | |

Note: For best results with less vibration, anchor system should be independent of court. If pouring concrete for both at same time, add an expansion joint in between.

Note: When digging hole, if you hit rock and cannot dig through contact a contractor.

1. Determine the location of the anchor system. The proper location is as close to the court without making contact, as shown in Figure 1. This, however, is a general rule. If you need to locate the anchor system in a location other than this, use the following dimensions as a guide.

Overhang when adjusted to 10 ft. = 27"

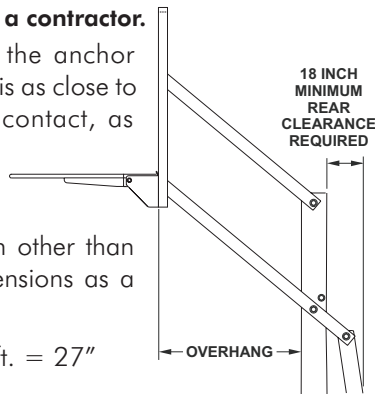

Note: Minimum of 18" rear clearance is required behind pole.

2. Assemble anchor system as follows: Thread nut (#35) to bottom of threads on anchor bolt (#39) insert threads of anchor bolt (#39) through hole on anchor plate (#38) and secure with nut (#35). Repeat this step for the remaining anchor bolts. See Figure 2. Note: Each leg of anchor bolts should face the anchor bolt to the right. See Detail A.

**Detail A
Bottom View**

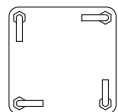

THESE NUTS
USED FOR
LEVELING

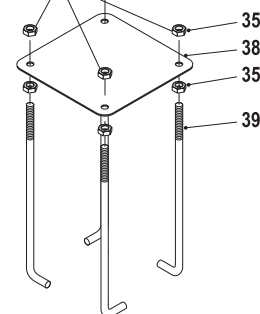
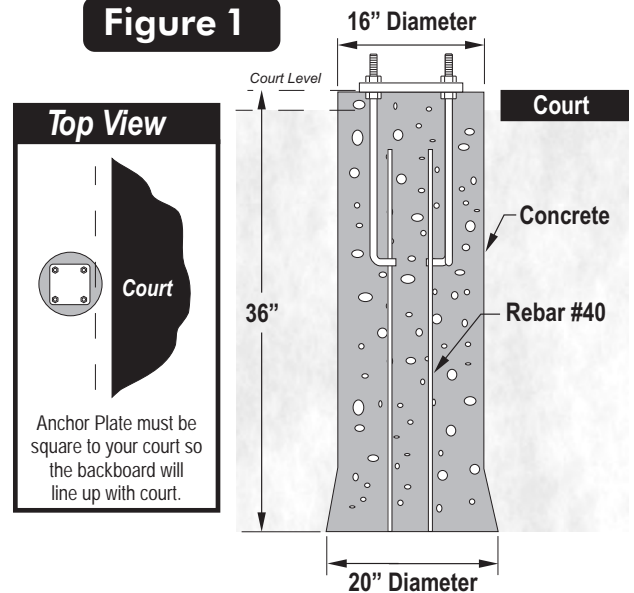

Figure 2

Figure 1



Note: It is recommended that you use some sort of concrete form for the top 4" of the concrete. Cardboard forms can be purchased at some hardware and home stores or a wooden form can be constructed out of 2 x 4's.

3. Mix and pour concrete into hole. Follow instructions on concrete bag. Stop about 18" below court level.
4. Insert four reinforcement bars (#40) into concrete 8" apart creating a square in center on hole.
5. Finish pouring concrete up to court level.
6. Push anchor system into concrete and agitate to work out voids in concrete. Immediately use a level to level and square anchor plate to playing surface. Clean off any concrete that may be on exposed threads.

Note: The bottom four nuts will be forever embedded in concrete. The top four nuts remain on bolts and are used for leveling. (See Step 14 on page 7).

Let concrete stand for a MINIMUM of 72 hours.

SILVERBACK ASSEMBLY INSTRUCTIONS (Day 5)

TOOLS REQUIRED FOR THE FOLLOWING STEPS

- | | |
|--|--------------------------|
| 1 - 15/16" Open end Wrench | 1 - Phillips Screwdriver |
| 1 - 15/16" Socket and Ratchet (optional) | 1 - Level |
| 1 - 9/16" Deep Well Socket & Ratchet | 1 - Tape Measure |
| 1 - 9/16" Open end Wrench | 1 - Rubber Mallet |
| 1 - 3/4" Socket & Ratchet | 1 - Set of Padded |
| 1 - 3/4" Open end Wrench | Saw Horses |
| 1 - Pair of Safety Glasses | |

IMPORTANT! Nylon washers (#5) adequately space painted parts at all pivot points. Neglecting the use of these washers will result in rusted parts.

NOTE: All board arms are made of rectangular tubing. Tightening hardware too tight may damage tubing and make adjustment of system difficult.

- Before putting any of the poles tubes together, mark bottom pole (#2) 6 inches from the top end. **Be sure to match up both "Back Side" stickers on the back of the poles and that the holes on top pole are toward the back.** See **Figure 3**.
- Align the upper pole (#3) with the bottom pole (#2) as shown in **Figure 3** and slide them together. Stand poles up on a block of wood, **lift poles up** and hit on a block of wood until the bottom of the upper pole reaches the 6" mark on the bottom pole. Hit poles a minimum of 7 times. This is a friction-locking joint and requires no hardware.

IMPORTANT! DO NOT hit poles with hammer or sledge hammer to slide poles together.

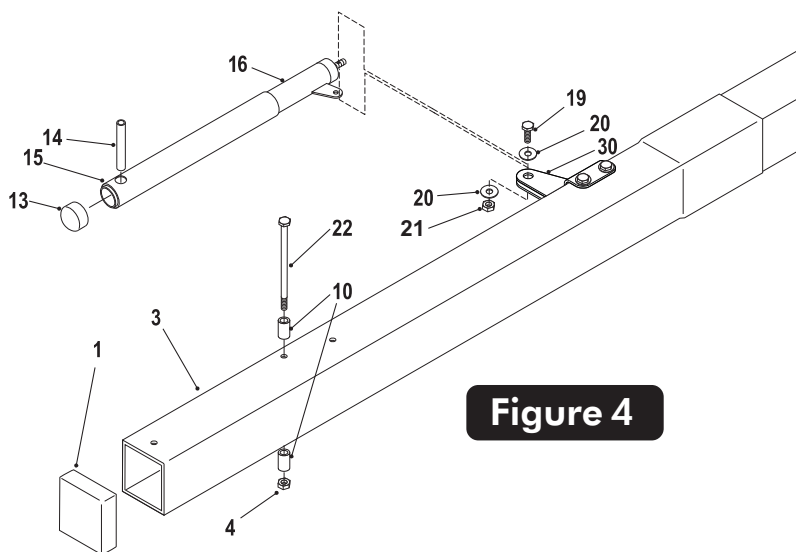

Figure 4

- Attach Post Ears (#30) to holes near the bottom of Top Post (#3) using two hex bolts (#25) four washers (#18) and two lock nuts (#4). See **Figure 3**.
- Slide Actuator Sleeve (#15) over Actuator (#16) and place Actuator Cap (#13) on top. Slide Pivot Tube (#14) through hole near top of Actuator & Actuator Sleeve until equal amounts stick out through both sides of Actuator. See **Figure 4**.

Note: If necessary, use a rubber mallet to tap in Pivot Tube (#14)

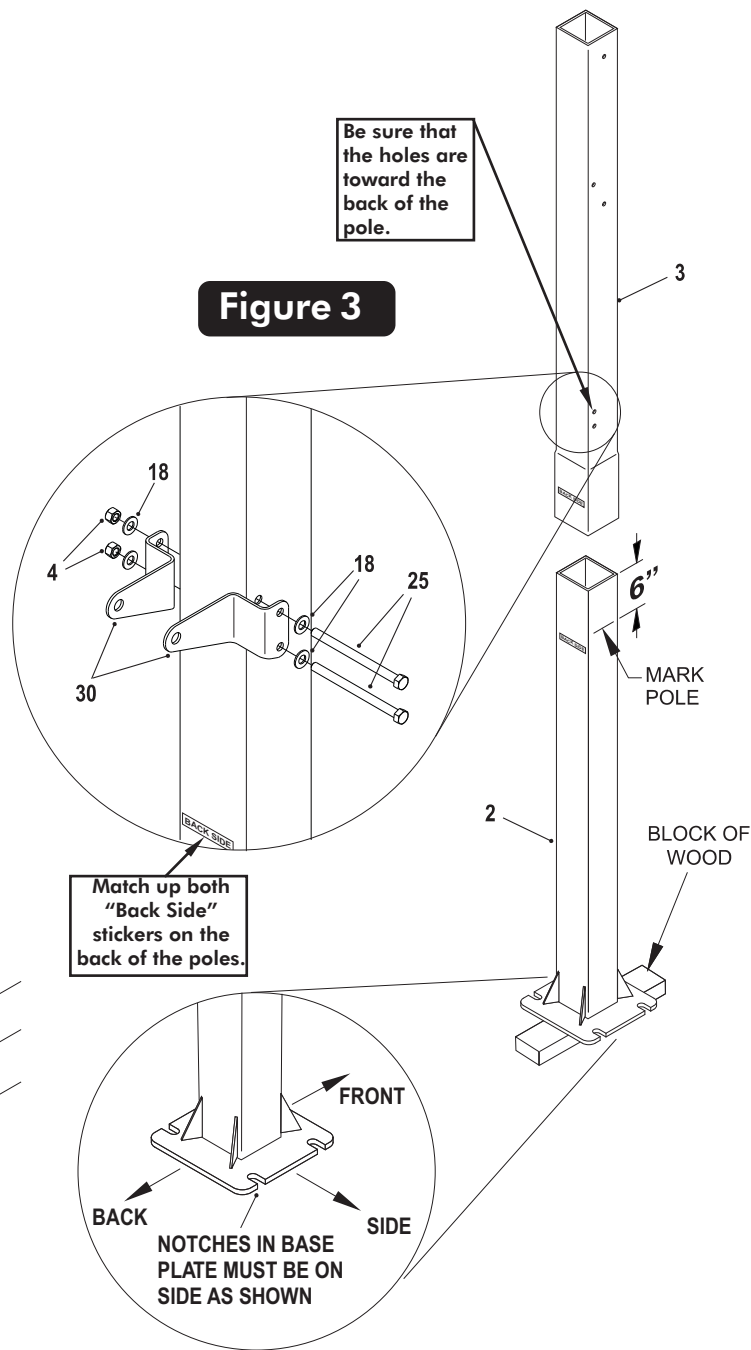

Figure 3

- Lay Pole Assembly on its side on two padded saw horses. Slide tab on Actuator (#16) between Post Ears (#30) and secure using one bolt (#19), two washers (#20) and one lock nut (#4). See **Figure 4**. Tighten bolts tight.
- Place Pole Cap (#1) onto top of Top Pole (#3). **Note:** Pole Cap may be pre-installed by the factory.
- Secure two stop spacers (#10) to pole, as shown in **Figure 4**, using one hex bolt (#22) and one lock nut (#4).

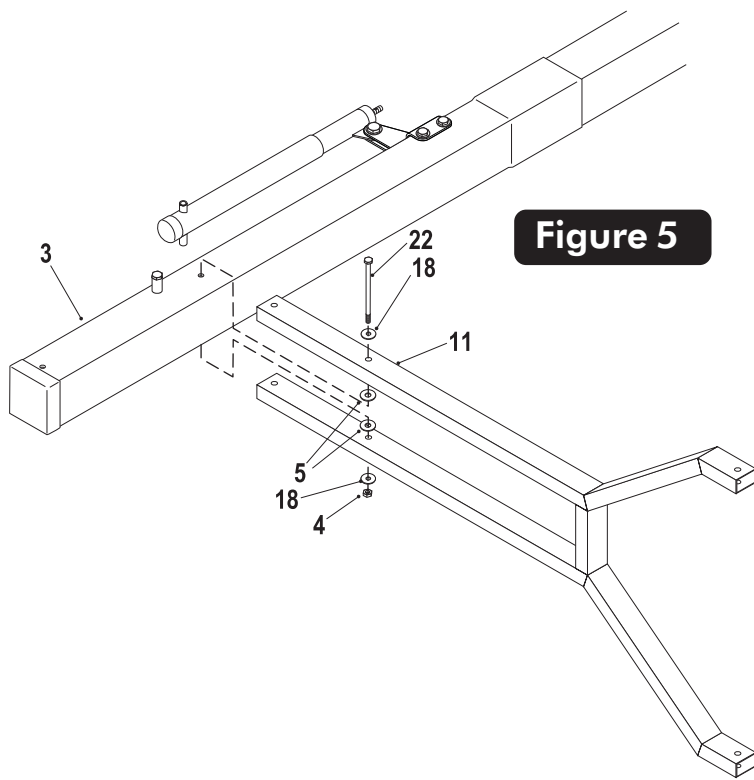
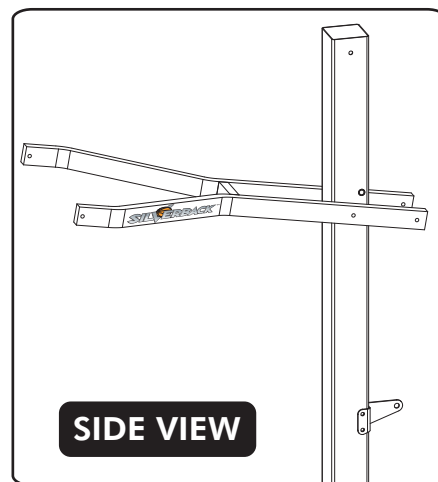

Figure 5

8. Attach lower arms (#11) to Top Pole (#3), as shown in Figure 5, using a hex bolt (#22), two flat washers (#18), two plastic washers (#5) and lock nut (#4).

Note: make sure lettering is right side up. (See Side View). DO NOT tighten bolt (#22) at this time. (See Figure 5.)



SIDE VIEW

9. Secure Actuator (#16) to Lower Arms (#11) using one bolt (#22), two flat washers (#18), two plastic washers (#5) and one lock nut (#4). See Figure 6. Tighten both bolts (#22) securing Lower Arm (#11).

Note: Tighten bolts snug but, do not over tighten. Board Arms must pivot freely.

10. Insert four Tube Plugs (#9) into open ends of Lower Arms (#11). It may be necessary to use a rubber mallet to tap them in. See Figure 6. **Note: Tube plugs may be pre-installed by the factory.**

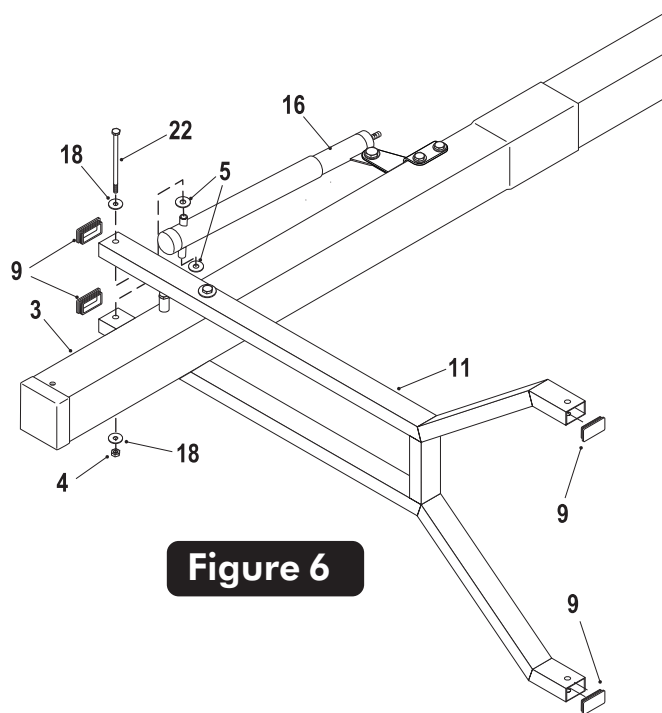

Figure 6

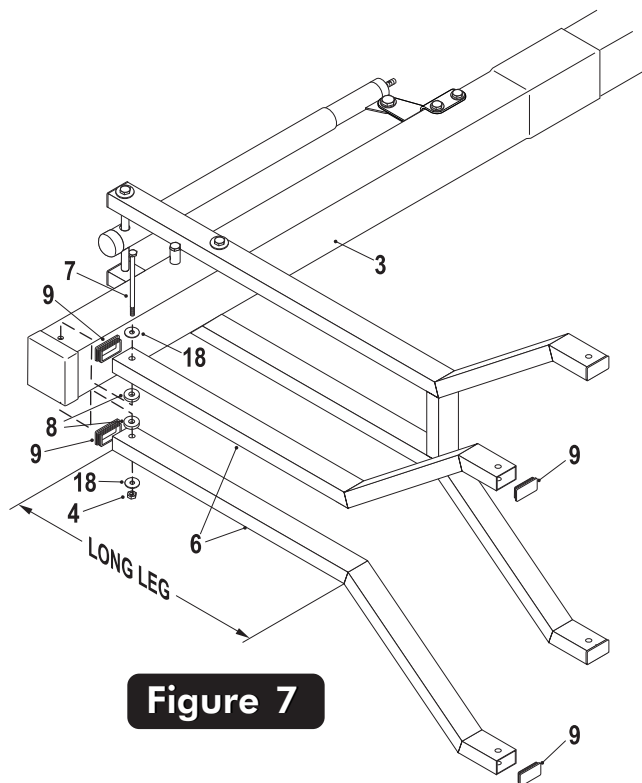

Figure 7

11. Attach long leg of Upper Arms (#6) to Top Pole (#3), as shown in Figure 7, using a bolt (#7), two flat washers (#18), two spacers (#8) and one lock nut (#4).

Note: Tighten bolts snug but, do not over tighten. Board Arms must pivot freely.

12. Insert four Tube Plugs (#9) into open ends of Upper Arms (#6). It may be necessary to use a rubber mallet to tap plug in. See Figure 7. **Note: Tube plugs may be pre-installed by the factory.**



**PLACING THE POST ON THE ANCHOR SYSTEM
REQUIRES AT LEAST FOUR CAPABLE ADULTS.
POLE WILL WANT TO LEAN WHILE ATTEMPTING TO
STAND IT UP ON ANCHOR BOLTS.**

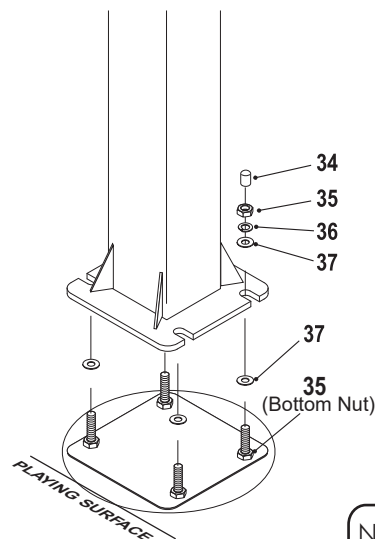

Figure 8

**BE SURE CONCRETE
HAS BEEN ALLOWED
TO CURE FOR AT
LEAST 3 DAYS**

Note: Bottom nuts #35 can
be used for leveling system.
See Step 14.

15. Slide Actuator Crank (#42) onto shaft on the bottom of Actuator (#16). Line up hole in shaft with hole in Actuator Crank and insert Pin (#41) to secure. See Figure 9.

16. To aid in the assembly of the backboard, lower the backboard, by turning the Actuator Crank, until the lower arm makes contact with Stop Spacer (#10).

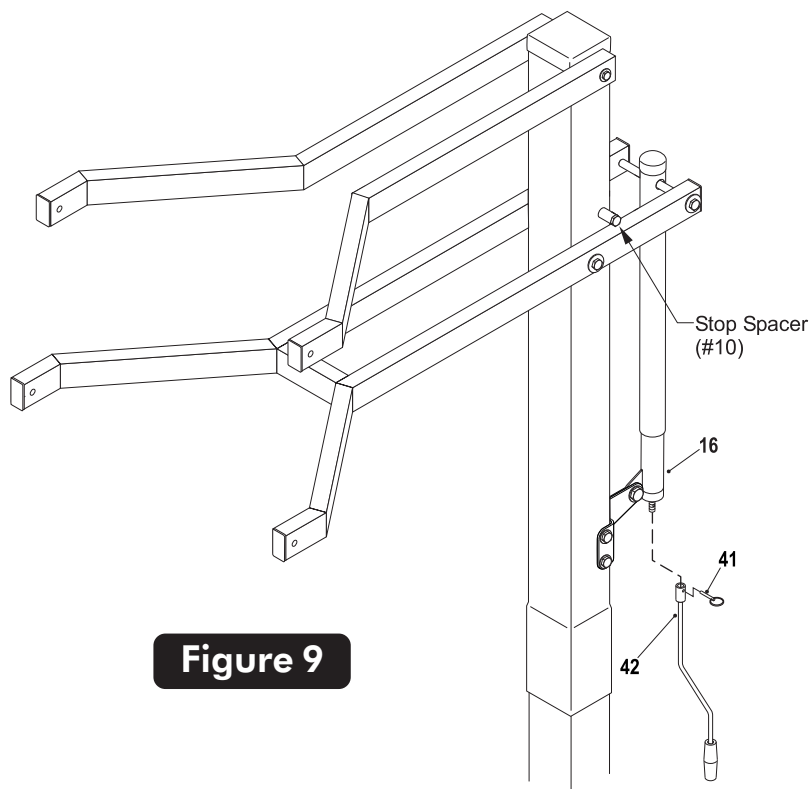
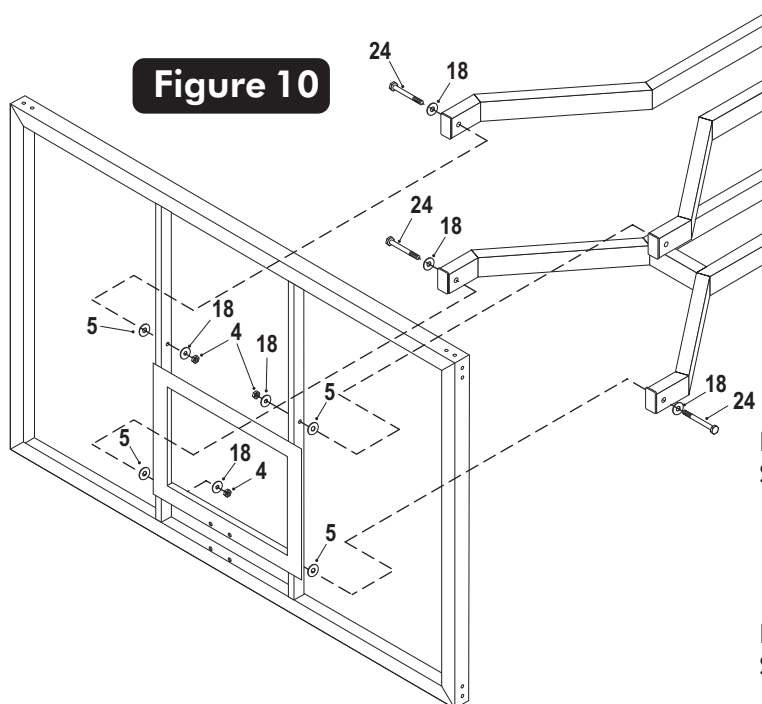

Figure 9

Figure 10



**ATTACHING BACKBOARD TO BOARD ARMS
REQUIRES AT LEAST FOUR CAPABLE ADULTS.**

17. With at least three capable people, raise the backboard assembly up and have the fourth attach Lower Board Arms to lower mounting tubes on backboard using two bolts (#24), two plastic washers (#5), four washers (#18) and two lock nuts (#4). See Figure 10.

**NOTE: DO NOT over tighten these bolts. This is a pivot point.
Snug is tight enough.**

18. Attach Upper Board Arms to upper mounting tubes on backboard using two bolts (#24), two plastic washers (#5), four washers (#18) and two lock nuts (#4). See Figure 10.

**NOTE: DO NOT over tighten these bolts. This is a pivot point.
Snug is tight enough.**

Figure 11

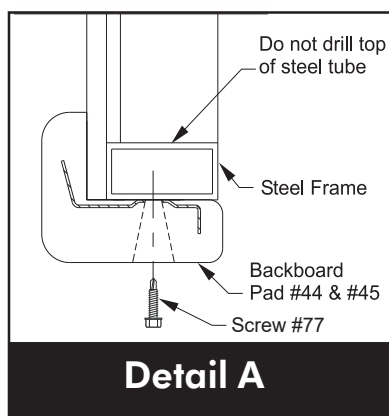
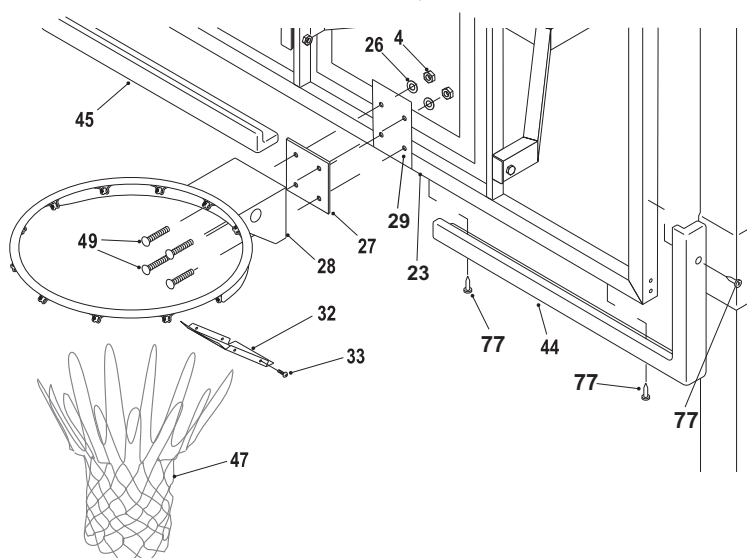

26. Adjust unit to 7-1/2 feet. Use a tape measure to measure from the top of the rim to the playing surface. Stick Height Decal (#17) to back of Actuator (#16) with the "7.5" mark aligned with bottom of Actuator Sleeve (#15). See Figure 12.

19. Remove protective backboard covering and mount Goal Assembly (#28) and Rim Pad (#27) to Backboard, as shown in Figure 11, using four bolts (#26), four washers (#27), and four locknuts (#4). Tighten fasteners finger tight, leave them loose enough to level rim.
20. Place a level across rim assembly and adjust rim until it is level. Finish tightening the four nuts.



NEVER USE RIM WITH COVERPLATE REMOVED!

21. Attach Rim Cover Plate (#32) using four screws (#33). See Figure 11.
22. Check all nuts and bolts and make sure everything is tightened properly. **DO NOT over tighten** pivot points, snug is tight enough.
23. Use the Backboard Pads (#44) and (#45) as a template and mark the hole locations on the backboard frame. See Figure 11 and Detail A.
- Note: Safety glasses required for Step 24.**
24. Drill 9/64" pilot holes into steel backboard frame. See **Detail A. Do not drill through both sides of tube.**
25. Secure Backboard Pads (#37) and (#38), as shown, using screws (#42). Note: Tighten screws tight but, **do not over tighten screws.**

Note: Cordless drill recommended for screw installation. Do not over tighten screws.

Figure 12

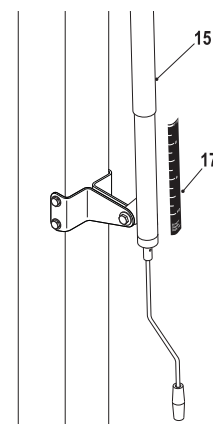

Two adults are recommended for this step, one to level and one to adjust the bottom #35 nuts.

27. If further leveling is required loosen top #35 nuts but do not loosen past the top of #39 "J" Bolt. **DO NOT REMOVE NUTS #35.** Place a level on pole and adjust bottom nuts #35 with a 15/16" open end wrench until pole is level. Tighten top #35 hex nuts. See Detail B.

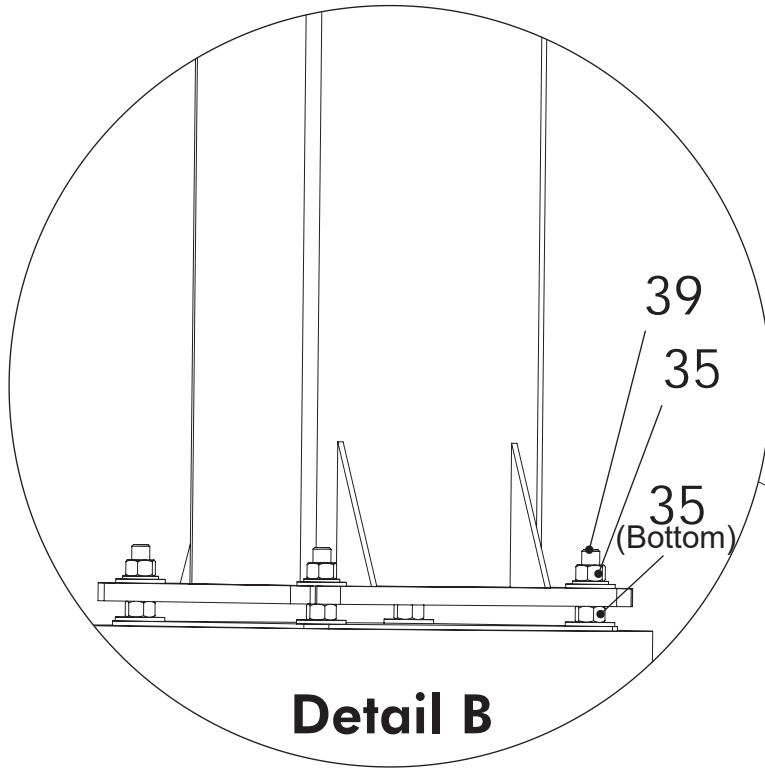
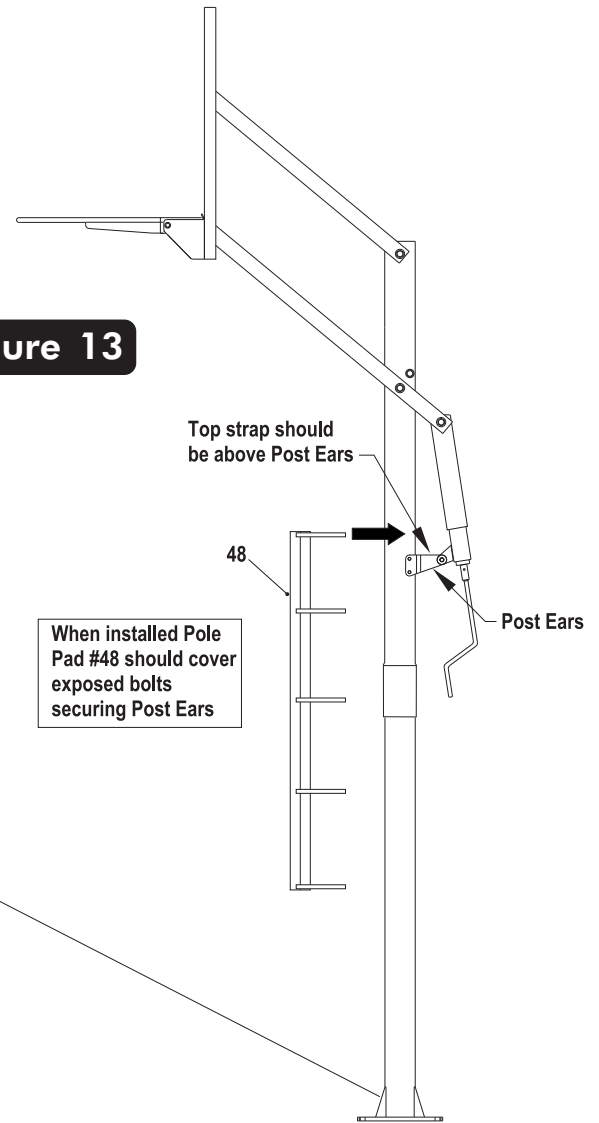

Figure 13



28. Secure Post Pad (#48) to front of pole by wrapping straps around pole and sticking to velcro on opposite side of Pad. Top Post Pad strap should be above Post Ears. See Figure 13.

⚠ WARNING ⚠

Protruding bolts can cause serious injury. Never use this unit without Pole Pad (#48) firmly in place and covering Post Ear bolts. If Pole Pad is damaged, replace before using this unit.

LIMITED 7 YEAR WARRANTY

This consumer warranty extends to the original consumer purchase of any Escalade® Sports Product (hereinafter referred to as the "Product").

WARRANTY COVERAGE: Escalade® Sports warrants to the original Consumer Purchaser that any Product of its manufacture is free from defects in material and workmanship. THIS WARRANTY IS VOID IF THE PRODUCT HAS BEEN DAMAGED BY ACCIDENT, UNREASONABLE USE, NEGLIGENCE, IMPROPER SERVICE, FAILURE TO FOLLOW INSTRUCTIONS PROVIDED WITH THE PRODUCT OR OTHER CAUSES NOT ARISING OUT OF DEFECTS IN MATERIAL OR WORKMANSHIP.

Subject to proper installation and normal Residential use, Escalade® Sports warrants, subject to the limitations below, to the original retail purchaser all structural components of the Silverback® System to be free of defects in material and workmanship for a period of Seven (7) years from the original purchase.

Merchandise must be shipped prepaid with a copy of proof of purchase to Escalade® Sports factory for examination to determine if the basketball system needs to be repaired or replaced. Any labor costs, travel expenses and any other changes involved in the removal, installation or replacement of the defective/repaired parts from/to your Silverback® System will be the purchaser's responsibility. Shipping charges for replaced or warranted merchandise sent back to the customer from Escalade® Sports factory must be prepaid by the customer in advance. If not, the replacement shipment will be sent out collect.

Escalade® Sports reserves the right to examine photographs or physical evidence of merchandise claimed to be defective, and to recover said merchandise, prior to authorization of warranty claims. A "Returned Goods Authorization" number may be required, please call for details prior to the return of any photographs or merchandise.

This limited 7 year warranty is expressly in lieu of all warranties, expressed or implied, including warranties of merchantability or fitness for use. Escalade® Sports does not assume or authorize any person or representative to assume for us, any other liability in connection with the sale of our products.

The remedy of repair or replacement stated above is Escalade® Sports exclusive remedy. Escalade® Sports will not be liable for any other damages or expenses which may incur, including but not limited to incidental or consequential damages. Escalade® Sports assumes no other obligations or liability on the part of the purchaser, and Escalade® Sports neither assumes nor authorizes any other person to assume for it any other liability in connection with the goods sold.

This warranty shall not apply in any manner to parts or accessories not manufactured by Escalade® Sports.

NOT COVERED BY THIS WARRANTY

- Merchandise not intended to be in places of public assembly, such as, but not limited to, schools, parks, public or private recreational facilities.
- Any merchandise subjected to Non-residential abuse, negligence, improper installation, vandalism, acts of God, alteration of product, or any other events beyond the control of Escalade® Sports.
- Paint or rusted parts. If rust should appear, remove loose paint, sand lightly, primer and paint with exterior flat matte finish enamel paint.
- HANGING ON RIM WILL VOID THE WARRANTY: Rims are not warranted for any defects other than workmanship. Torn back plates, damaged springs, bent rings, damaged eyebolts, and torn or distorted rim supports result from hanging on the rim and are not warranted.
- Shipping charges both ways. Note: Any merchandise shipped to Escalade® Sports collect will be refused.
- Dealer service charges, labor charges and travel expenses associated with replacement of repair of warranty item.

WARRANTY DISCLAIMERS: ANY IMPLIED WARRANTIES ARISING OUT OF THIS SALE, INCLUDING BUT NOT LIMITED TO THE IMPLIED WARRANTIES OF MERCHANTABILITY AND FITNESS FOR A PARTICULAR PURPOSE, ARE LIMITED IN DURATION. ESCALADE® SPORTS SHALL NOT BE LIABLE FOR LOSS OF USE OF THE PRODUCT OR OTHER CONSEQUENTIAL OR INCIDENTAL COSTS. EXPENSES OR DAMAGES INCURRED BY THE CONSUMER OF ANY OTHER USE.

Some states do not allow the exclusion or limitation of implied warranties or consequential or incidental damages, so the above limitations or exclusions may not apply to you.

LEGAL REMEDIES: This warranty gives you specific legal rights, and you may also have other rights which may vary from state to state.

WARRANTY GUIDELINES IS REQUIRED FOR ALL WARRANTY CLAIMS

1. Proof of Purchase (original retail purchaser) is required for all warranty claims.
 2. Call or write Escalade® Sports to receive a Return Authorization # and determine specific needs.
- Phone: 1-888-USA-GOAL / Warranty Dept.
Or Write Escalade® Sports at: Escalade® Sports - P.O. Box 889, Evansville, IN 47706 - Attn: Warranty Dept.
Or E-mail us at: basketball@escaladesports.com

SILVERBACK CARE INFORMATION

- BACKBOARD -

Items needed to clean backboard:

- 100% cotton soft cloth, (only)
- Glass Cleaner

Clean backboard using a **100% Cotton** soft cloth and glass cleaner. Clean glass as you would household windows. Strong cleansers will damage backboard and void warranty.

- RIM -

HANGING ON THE RIM WILL VOID YOUR WARRANTY. Rims are not warranted for any defects other than workmanship. Torn back plates, damaged springs, bent rings, damaged eye bolts, and torn or distorted rim supports result from hanging on the rim and are not warranted.

The goal should not be cranked under 7-1/2' or over 10'. Adjustments of the goal should be done under adult supervision.

When attempting slam dunk activity you should always wear a mouth guard to avoid dental injury.

B5402 REPLACEMENT PARTS LIST

Key#	Part #	Description	Qty.
1	3M-6850-00	4" Square Tube Plug	1
2	1A-6335-02	Bottom Post	1
3	8S-6644-02	Top Post	1
4	901-28	3/8-16 Nylon Locknut	14
5	3M-6883-00	1-1/4" OD Plastic Washer	8
6	8S-6630-01	Upper Board Arm	2
7	1B-6483-10	3/8-16 X 7.5" Hex Bolt-Grade 5	1
8	3M-6269-00	1/4" Spacer	2
9	3M-6548-00	1 X 2 Tube Plug	8
10	8S-6657-00	Stop Spacer	2
11	1A-6331-01	Lower Board Arm	1
12	Not Used		
13	3M-6467-00	Actuator Cap	1
14	8S-6658-00	Pivot Tube	1
15	3M-6542-00	Actuator Sleeve	1
16	4A-6605-00	Actuator	1
17	4L-7501-00	Height Decal	1
18	701-50	3/8 STD Washer	18
19	1B-6486-10	1/2-13 X 1-1/2" Hex Bolt	1
20	2B-6093-00	1/2 Flat Washer	2
21	2B-6095-00	1/2-13 Nylon Locknut	1
22	1B-6484-10	3/8-16 X 7" Hex Bolt-Grade 5	3
23	6A-7404-01	Backboard Assembly-60x33" Glass	1
24	1B-6195-00	3/8-16 X 2.75" Hex Bolt	4

Key#	Part #	Description	Qty.
25	1B-6485-10	3/8-16 X 5" Hex Bolt	2
26	2B-6114-00	3/8 Flat Washer	4
27	3M-6473-00	3X4 Rim Pad	1
28	6A-6374-00	Goal Assembly	1
29	3M-6835-00	Goal Spacer Plate (Pre-Installed)	1
30	2S-6795-01	Post Ear	2
31	Not Used		
32	2S-6427-00	Rim Cover Plate	1
33	1B-6788-00	#8 x 1/2 Thread Forming Scr.	4
34	3M-6469-00	5/8 Thread Protector	4
35	2B-6097-00	5/8-11 Hex Nut	12
36	2B-6099-00	5/8 Split Lockwasher	4
37	2B-6098-01	5/8 SAE FLAT WSHR ZNC	8
38	2S-6453-00	Anchor Template	1
39	2B-6112-00	5/8-11 X 14 "J" Bolt	4
40	1S-6167-00	#3 X 30" Rebar	4
41	7B-6255-00	Pull Pin	1
42	4A-6606-00	Actuator Handle	1
43	2L-7198-00	This Manual	1
44	3M-6580-01	48" Board Pad Right	1
45	3M-6581-01	48" Board Pad Left	1
46	Not Used		
47	3F-6010-00	Net	1
48	3M-6564-01	Post Pad	1
49	1B-6782-00	3/8-16 x 1 3/4" Carriage Bolt	4
50	Not Used		
77	1B-6821-00	Self Tapping Screw-#10 x 1 1/8"	6

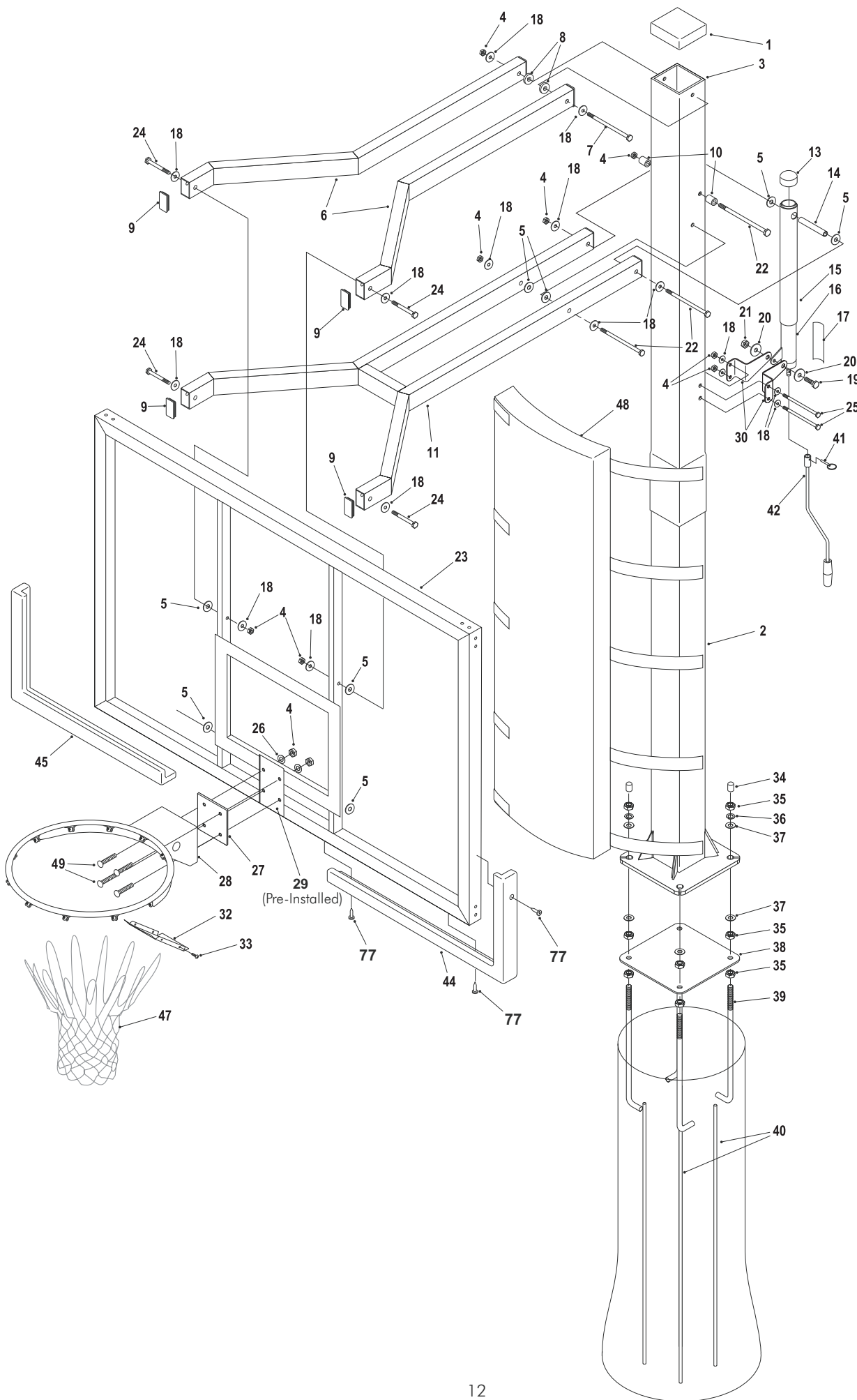

SPECIFICATIONS:

OPEN TIMBER TRUSS GABLES

MATERIAL AND QUALITY ASSURANCE. Structural glue laminated timber shall be in conformance with AITC Standard (latest edition). Species: Laminating lumber shall be kiln-dried, architectural grade, sealed and wrapped. The roof system for wood structures and buildings are designed to withstand 30 PSF live load and 20 PSF wind load. Please check local codes. For heavier load requirements, please consult with Cedar Forest Products Company. The standard roof slope shall be 4/12.

LAMINATED SUPPORT COLUMNS

MATERIAL AND QUALITY ASSURANCE. Structural glue laminated timber shall be in conformance with AITC (latest edition). Species: Laminating lumber shall be kiln-dried Port Orford Cedar, architectural appearance grade. Laminated columns shall be sized to suit loading requirements. Manufacturers shall furnish connection steel and hardware for joining structural glue laminated timber members to their supports, exclusive of anchorage and embedment in masonry or concrete (anchor bolts are not furnished).

CONNECTOR PLATES

Plates shall be fabricated from structural steel ASTM-A-36.
Plates to be Powder Coated Black.
Hardware: A-325 zinc plated machine bolts and nuts.

ROOF DECKING

2" x 6" (nominal), #1 grade, single tongue and groove with V-joint on bottom face, kiln dried southern yellow pine, maximum moisture content shall be 19% or less selected for decking. Specified lengths, with all joints over supports.

SHINGLES 29 Gauge Metal roof in charcoal

~~Class "A" fire rated, architectural grade, laminated fiberglass shingle with a 30 year limited warranty. To be installed, over 30 lb. felt.
Roof application as per manufacturer's specifications.
Color to be approved by owner/design professional.~~

FASCIA

2x8nom A.Y.Cedar, "D"/ Better Grade, kiln-dried, Surfaced on Four Sides.

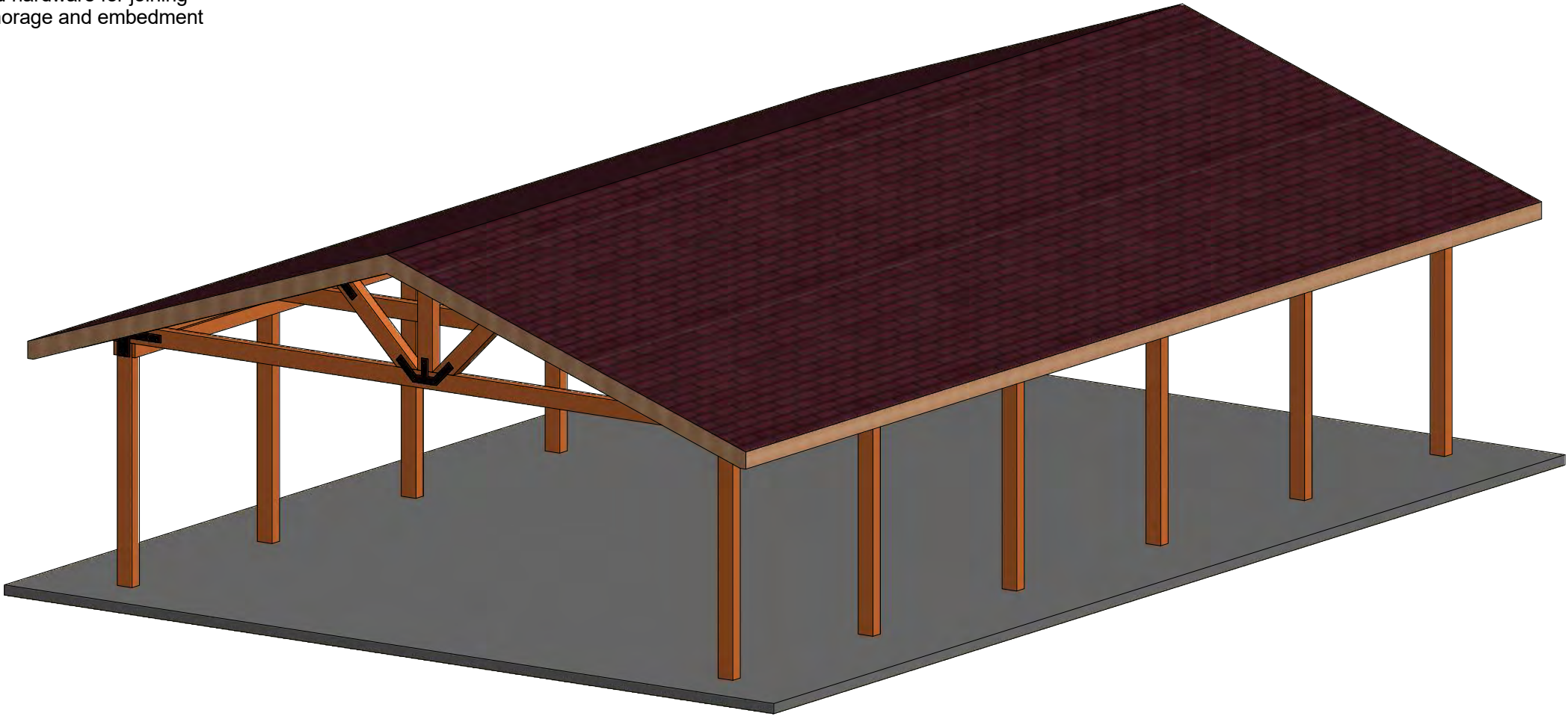

Jackson County Splash Pad
SPECIFICATIONS APPENDIX 1

PRELIMINARY LAYOUT
NOT FOR CONSTRUCTION



P.O. BOX 145
WEST OLIVE, MI 49460
800-552-9495
WWW.CEDARFORESTPRODUCTS.COM

DESCRIPTION:	MODEL #:	DATE:	JES DESIGN #:	REV:
28x44 Open Timber Truss	OTT2844	1/16/2019	OTT-STNRD	0

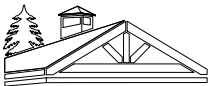
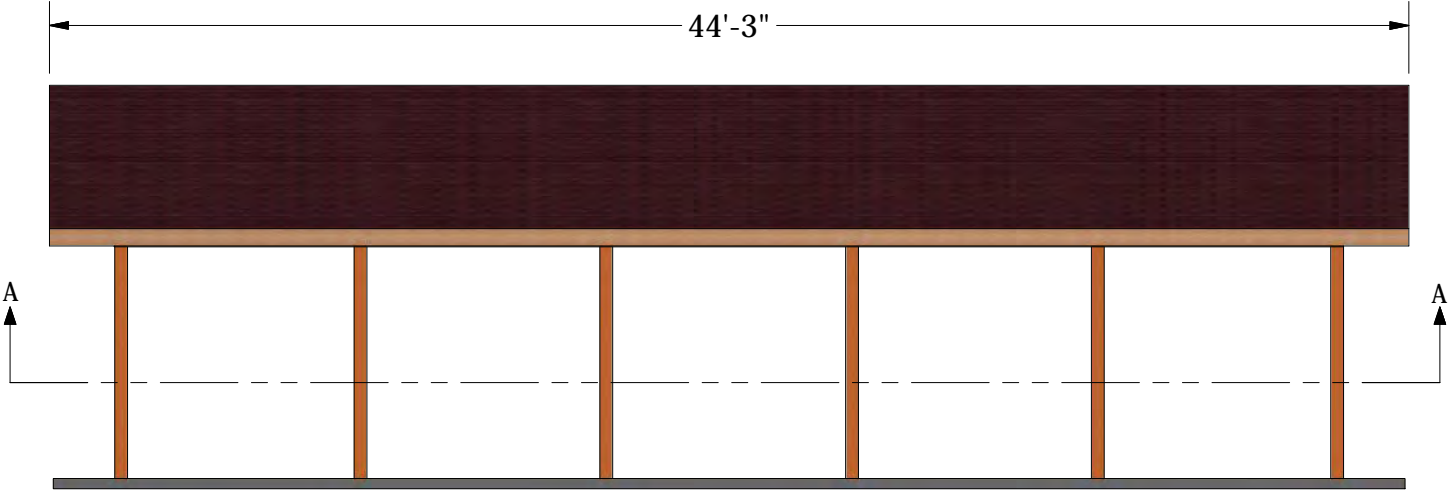
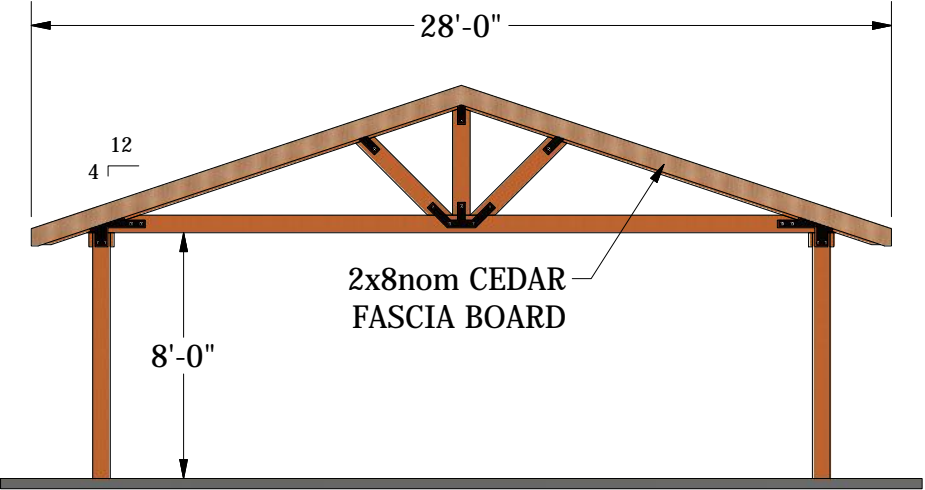
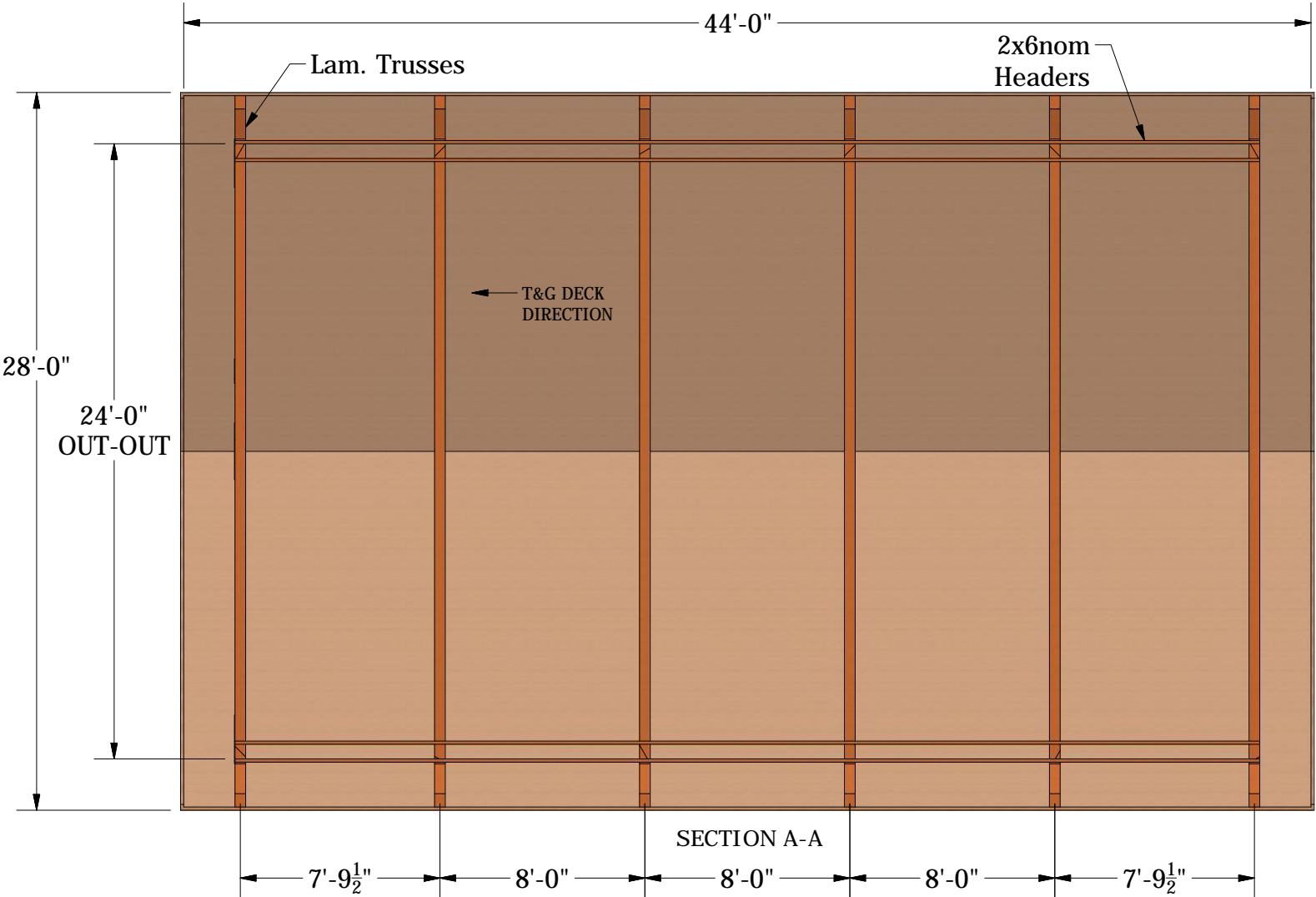
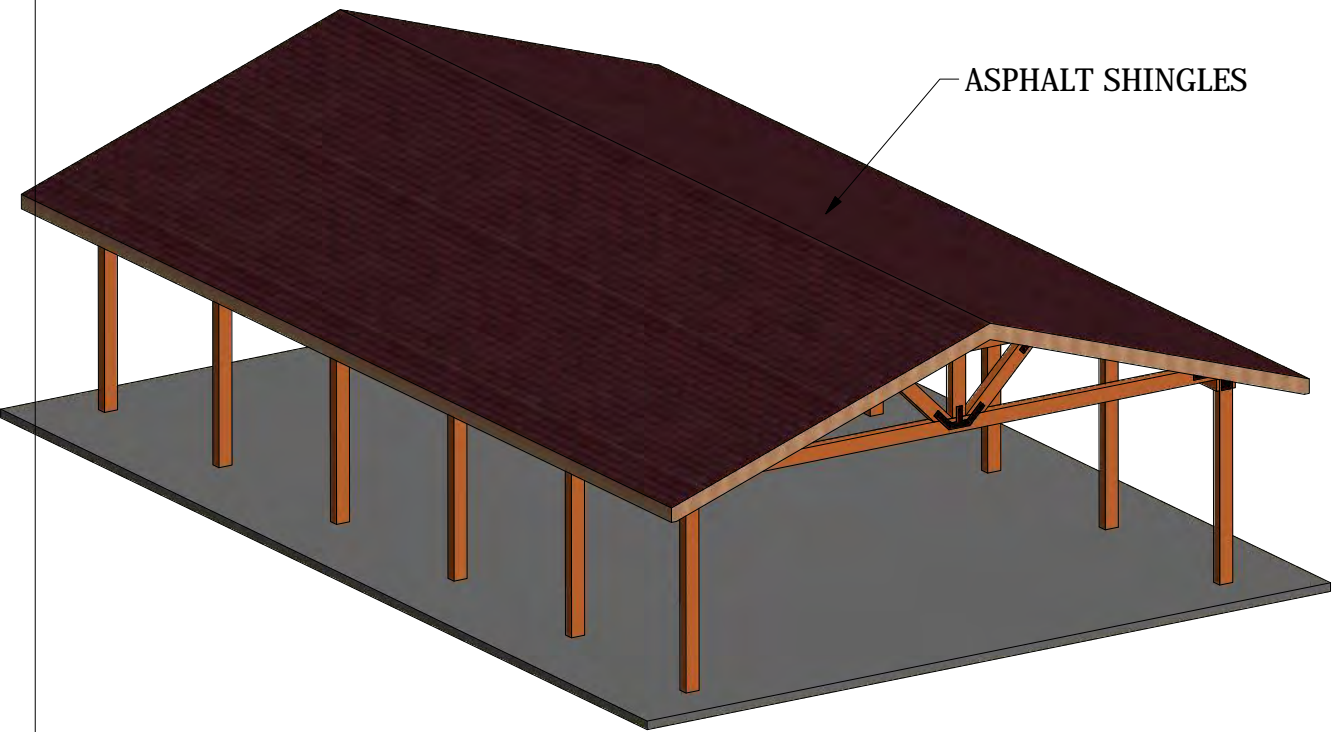

CFP

CEDAR FOREST PRODUCTS WWW.CEDARFORESTPRODUCTS.COM

P.O. BOX 145

WEST OLIVE, MI 49460

800-552-9495

Jackson County Splash Pad
SPECIFICATIONS APPENDIX 1

PRELIMINARY LAYOUT

NOT FOR CONSTRUCTION

DESCRIPTION:	MODEL #:	DATE:	JES DESIGN #:	REV:
28x44 Open Timber Truss	OTT2844	1/16/2019	OTT-STNRD	0

STANDARD IN-GROUND

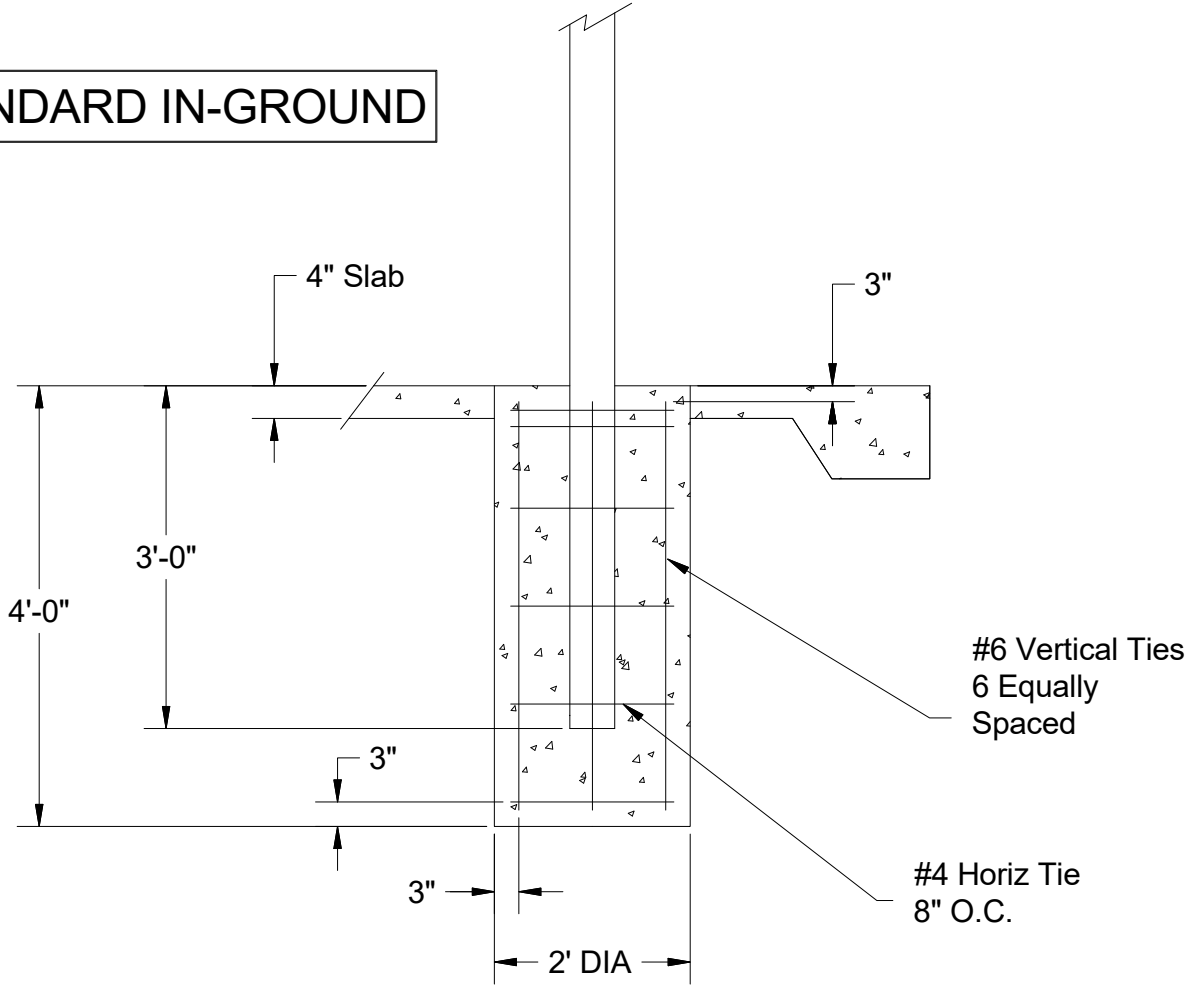

Column/Footing Detail
Final Size TBD
Concrete Pier By Others

OPTIONAL BASE SHOE

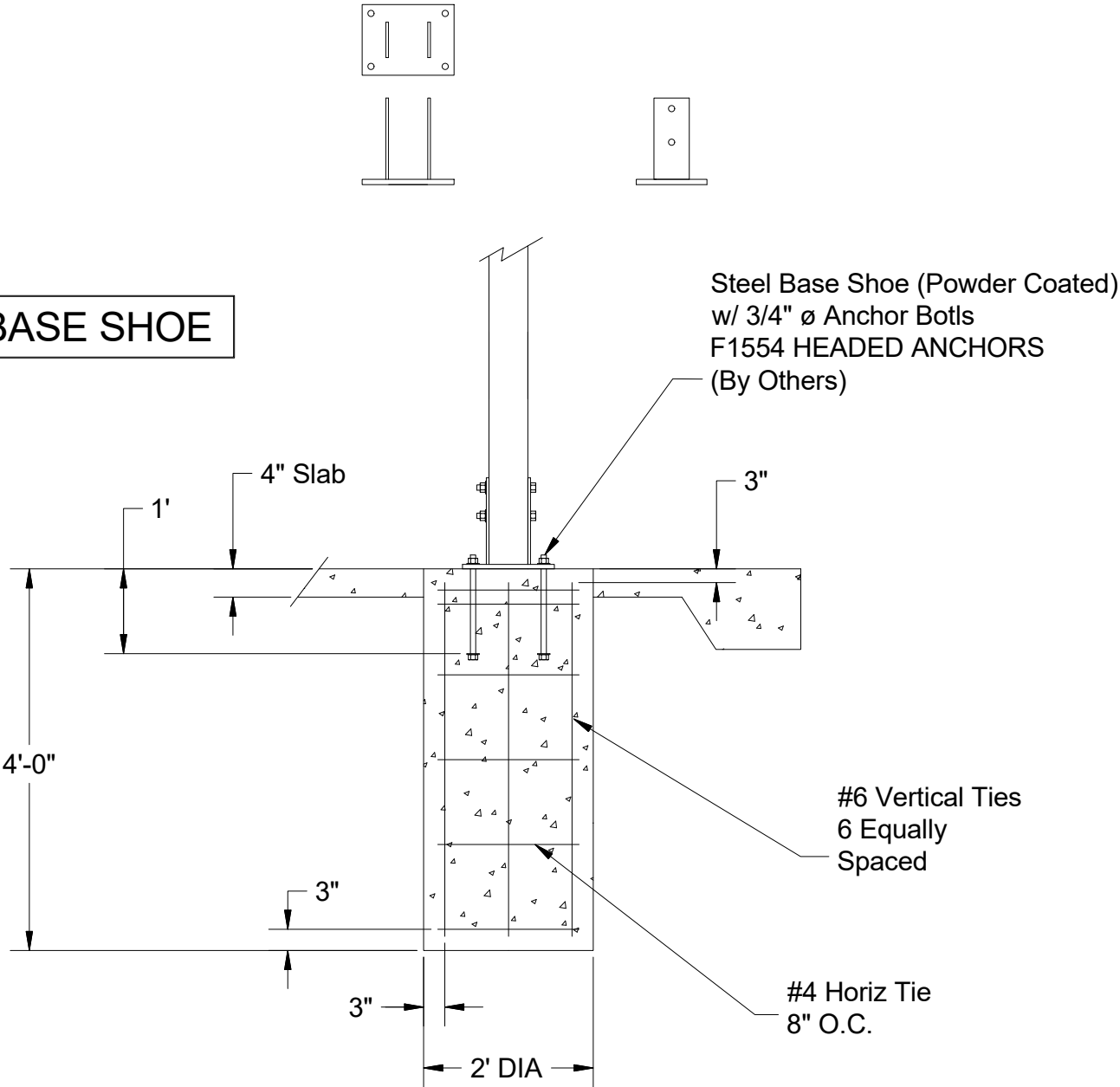

Column/Footing Detail
Final Size TBD
Concrete Pier By Others

Jackson County Splash Pad
SPECIFICATIONS APPENDIX 1

PRELIMINARY LAYOUT
NOT FOR CONSTRUCTION



P.O. BOX 145
WEST OLIVE, MI 49460
800-552-9495
WWW.CEDARFORESTPRODUCTS.COM

DESCRIPTION:	MODEL #:	DATE:	JES DESIGN #:	REV:
28x44 Open Timber Truss	OTT2844	1/16/2019	OTT-STNRD	0

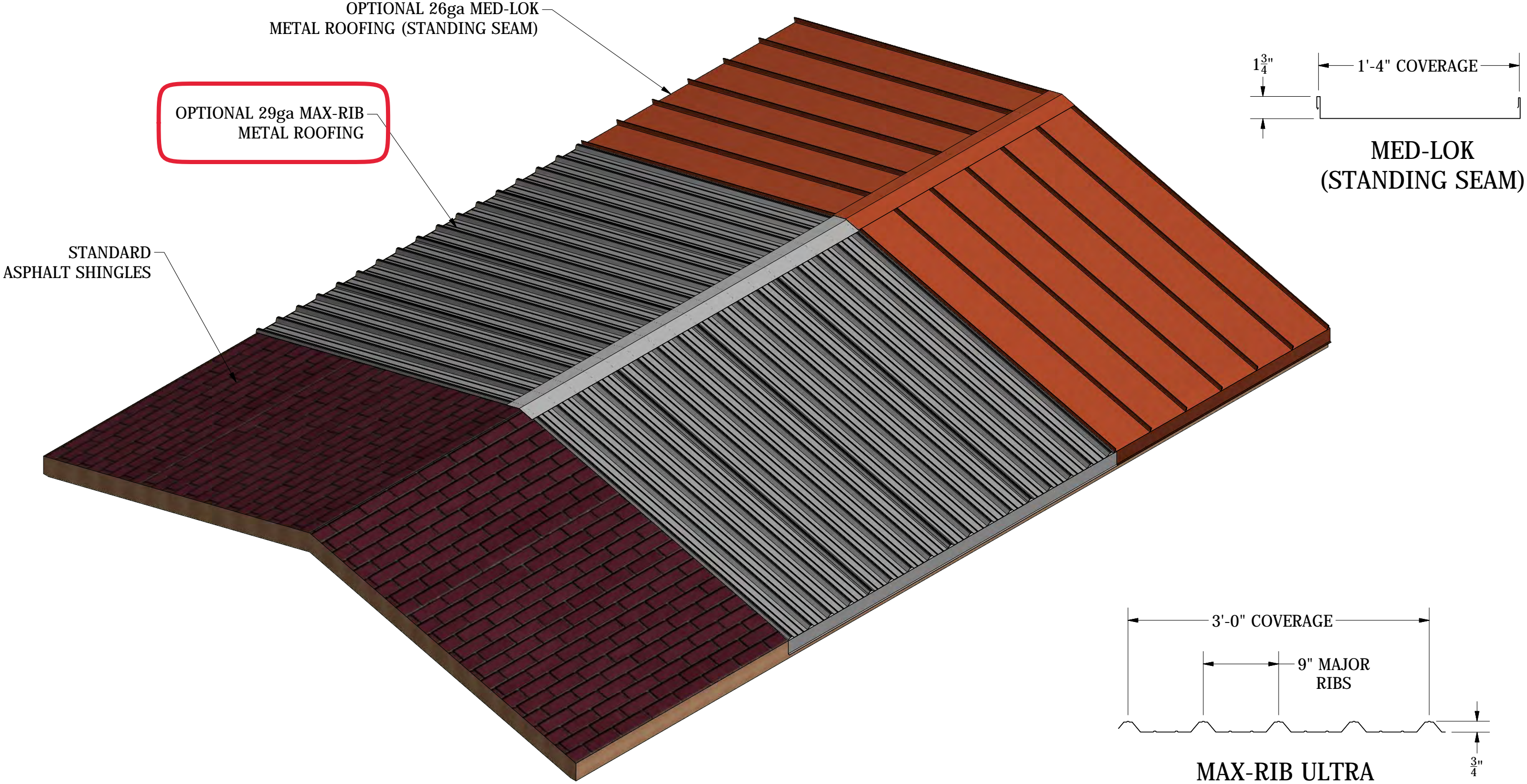

Jackson County Splash Pad
SPECIFICATIONS APPENDIX 1

PRELIMINARY LAYOUT
NOT FOR CONSTRUCTION



P.O. BOX 145
WEST OLIVE, MI 49460
800-552-9495
WWW.CEDARFORESTPRODUCTS.COM

DESCRIPTION:	MODEL #:	DATE:	JES DESIGN #:	REV:
28x44 Open Timber Truss	OTT2844	1/16/2019	OTT-STNRD	0

- NOTE:
- ALL CONCRETE SLOPES TO BE 1/8"/FT MIN. AND 1/4"/FT MAX.
 - SITE ELEVATIONS OF SPLASH PAD AND CONCRETE APRON TO BE VERIFIED BY OTHERS. AQUATIX ELEVATION REFERENCE IS 0'-0" FOR TOP OF DRAIN BOX. ALL OTHER NOTED ELEVATIONS ARE REFERENCED FROM THAT POINT.
 - REFER TO SPEC SHEET AND INSTALLATION DRAWING FOR EACH PRODUCT.
 - ACTUAL SIZE, SHAPE, AND LOCATION OF SPLASH PAD TO BE FIELD DETERMINED BY OTHERS. ALL DIMENSIONS OF SIZE AND SHAPE OF SPLASH PAD FOR REFERENCE ONLY.
 - THE INTENT OF A SPLASH PAD IS TO BE A DRY DECK WITH NO STANDING WATER. THE WATER IS TO BE CONTAINED WITHIN THE PERIMETER OF THE SPLASH PAD AND ALL WATER IS TO DRAIN INTO THE DRAIN BOXES. THE CONCRETE IS TO BE FORMED AND SLOPED TO ACCOMMODATE THIS DRAIN PATTERN.
 - ALL TREATED SPLASH PAD WATER IS INTENDED TO REMAIN WITHIN DESIGNATED SPLASH PAD DECK. UNDER NO CIRCUMSTANCES SHOULD SLOPE OF SPLASH PAD ALLOW WATER TO DRAIN OFF PAD.
 - UNDER NO CIRCUMSTANCES SHALL THE SURROUNDING HARDSCAPE AREA BE SLOPED TO ALLOW WATER TO BE DRAINED INTO THE SPLASH PAD DECK.
 - ALL CONCRETE SURFACES TO HAVE A MEDIUM BROOM FINISH.
 - COORDINATE EXPANSION JOINT AND SAW CUT LOCATIONS WITH PLAY EQUIPMENT LOCATIONS.
 - DRAWINGS ARE FOR DESIGN/LAYOUT PURPOSES ONLY. PLEASE SEE AQUATIX BY LANDSCAPE STRUCTURES FOR INCLUDED STRUCTURES, EQUIPMENT, SERVICES, AND EXCLUSIONS.
 - INDICATES SPLASH ZONE.
 - SPLASH ZONES ARE APPROXIMATE. ACTUAL SPLASH ZONE MAY VARY BASED ON VARIOUS ENVIRONMENTAL CONDITIONS, FLOW RATES, SLOPE OF THE SPLASH PAD, SUBMERGENCE DEPTH AND WIND.
 - DRAWINGS ARE SCHEMATIC ONLY.
 - 12" OF GRANULAR FILL RECOMMENDED, OR AS SOIL CONDITIONS AND/OR LOCAL CODE REQUIRES WITH A MINIMUM OF 2500 PSF SOIL BEARING CAPACITY.
 - THERE IS TO BE A MINIMUM OF 6" OF GRANULAR FILL AROUND ALL PIPING.
 - CONSTRUCTION OF SPLASH PAD CONCRETE TO BE 5" THICK, 4,000 PSI CONCRETE WITH #4 BARS SPACED 12" O.C. EACH WAY. CONCRETE PAD TO HAVE REQUIRED EXPANSION JOINTS EVERY 20' X 20', SAW-CUT JOINTS EVERY 10' AND THICKEN PROFILES AT EDGE OF PAD AND AT EACH STRUCTURE/EMBED.
 - CONSTRUCTION OF 5' APRON AROUND PERIMETER OF SPLASH PAD TO BE 4" THICK, WIRE MESH REINFORCED, 3500 PSI CONCRETE. APRON TO INCLUDE EXPANSION JOINT AT PERIMETER EDGE OF SPLASH PAD AND NEEDED SAW-CUT JOINTS.
 - SCHEDULE 80 PVC TO BE UTILIZED FOR ALL SPLASH PAD MECHANICAL SYSTEM PIPING.

SPLASH PAD AREA: 1,522 SQ. FT.
TOTAL FEATURE FLOW RATE: 125 GPM

Jackson County Splash Pad
SPECIFICATIONS APPENDIX 3

PRELIMINARY
FOR BID ONLY

NOT FOR
CONSTRUCTION

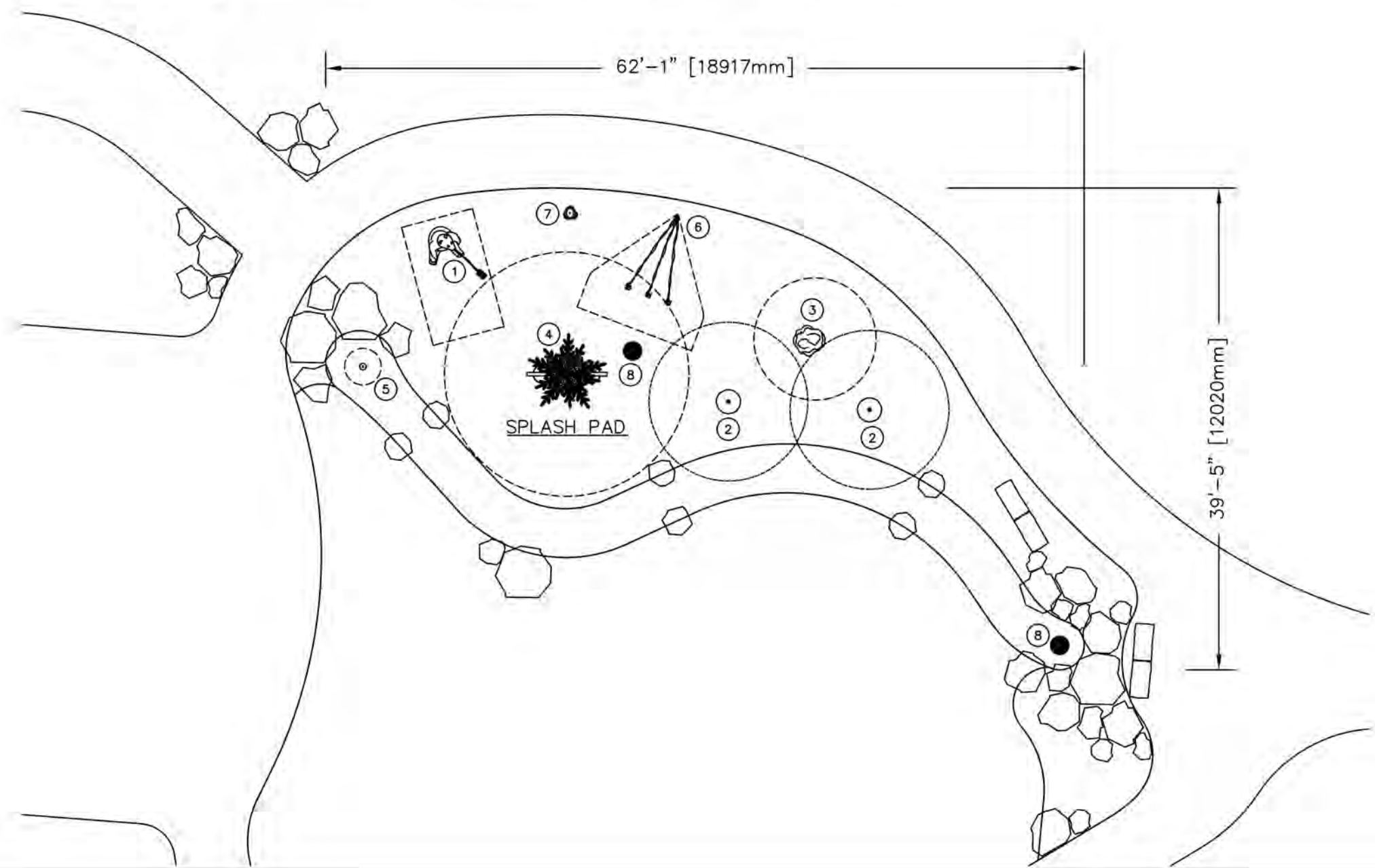
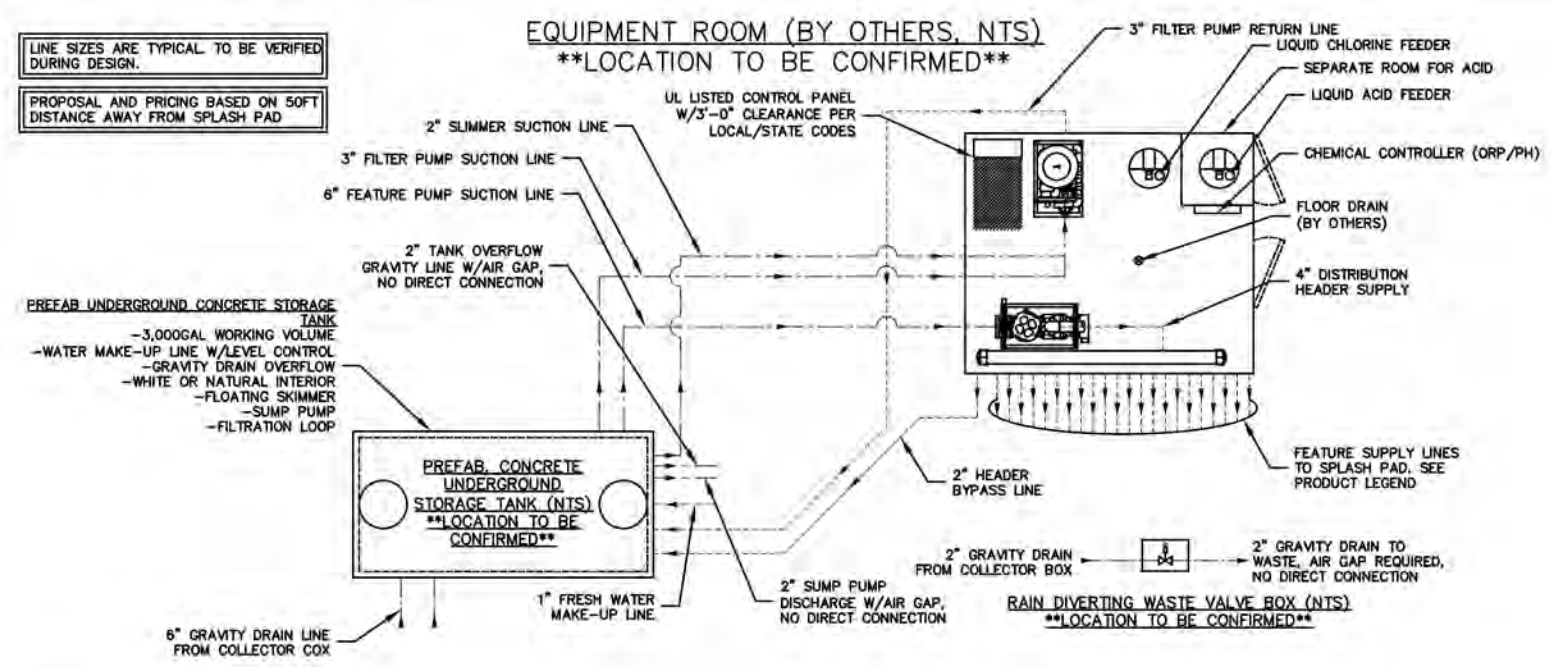

NO	PRODUCT	QTY	LINE SIZE	GPM
1	SPLASHPACK BEAR	1	1 1/2"	10
2	AQUAROCK SMALL	2	1" EA	10EA
3	STONE BOULDER	1	1 1/2"	10
4	TALL PINE BUCKET SHOWER	1	2 1/2"	70
5	BUBBLER	1	1"	10
6	TRIPLE ARCH JET	1	1"	5
7	AQUAVATOR	1	-	-
8	COLLECTOR BOX	2	-	-

DATE: _____

REVISION: _____

NO. _____

1101 MONROE PARKWAY
DOLAN, MI 48328
877-438-0903
aquatix@aquatix.com

aquatix
by landscape structures

JOB TITLE: CASHIERS
SPLASH PAD
LOCATION: CASHIERS, NC

DATE: 1/12/23

DWG. FILE: _____

CHECKED: _____

DRAWN: DPC

SCALE: NOT TO SCALE

SHEET TITLE: PROPOSED SPLASH PAD SCHEMATIC LAYOUT

JOB NO. 1171479-01-01

1 OF 1



Mechanical Activation Devices

Aquavator

Product Overview

Get the water play fun started with the Aquavator! When kids touch the splash graphic a signal activates all of the splash pad features, or designed zoned areas. A touch button within the face of the activation bollard safely encapsulates a low voltage sensor.



Product Specs

Material Options

Stainless Steel

Standard Flow Rate

na

Dimensions

3' 0" x 1'0"

(3,05 m x 0,30 m)

PSI

na

Splash Zone

na

Jackson County Splash Pad
SPECIFICATIONS APPENDIX 3

Structure:

Stainless Steel Fabrication
(see specification for details)

Acrylic Accents
(see specification for details)

Skirt
Fiberglass Fabrication
(see specification for details)

Collar
Urethane
(see specification for details)

Aquavator Data:

Recommended Distance From Aquavator(s) to
Control Panel 50'

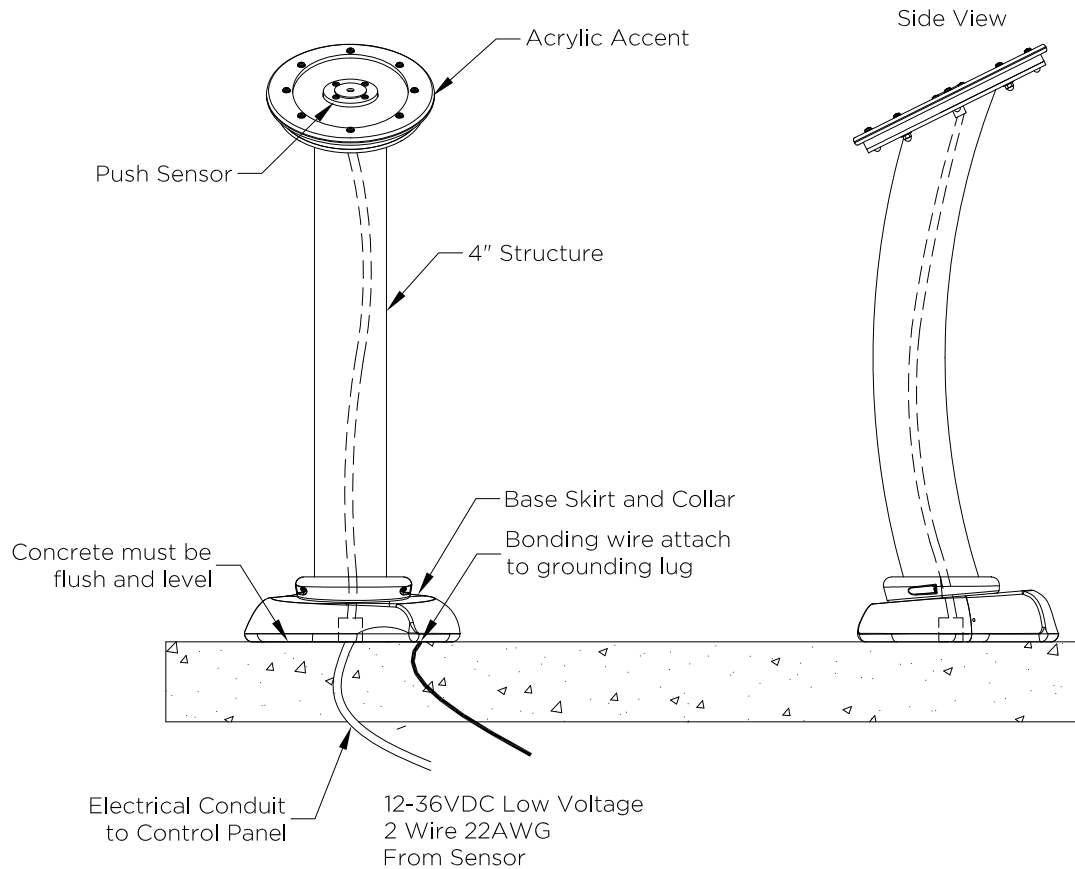

Jackson County Splash Pad
SPECIFICATIONS APPENDIX 3

Aquavator:

Model No.	Description
300126	Bulldog Aquavator



1101 McKinley Parkway
Delano, MN 55328
877-632-0503
Local 952-445-5135
aquatix.playlsi.com

AQUAVATOR

P.J.
DRAWN BY

1/4"=1'-0"
SCALE

1/10/22
DATE

This drawing is issued in confidence for engineering information only. This drawing shall remain the property of Aquatix and may not be reproduced, disclosed to a third party, or used to manufacture anything without direct written permission from Aquatix. Unauthorized use shall entitle Aquatix to all damages caused by such user including preparation charges, lost profits, damage to reputation and attorney's fees.



Collector Box to consist of 18 inch diameter PVC sump for collection of splash pad recirculation water. Each collector box is capable of 250 gpm gravity drainage using a 6 inch drain pipe sloped at 1/8 inch per foot slope to water reservoir tank.

May consist of:

- Structural plastic grating.
- Collector box to be blue

Collector box to have an auto drain feature that will evacuate all water to waste when system is not in operation. This feature minimizes the potential for contamination of the underground reservoir tank.

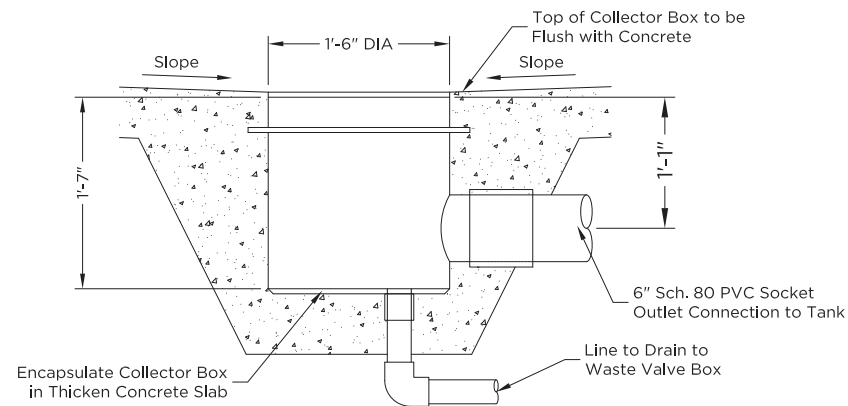

Collector Box

Jackson County Splash Pad SPECIFICATIONS APPENDIX 3

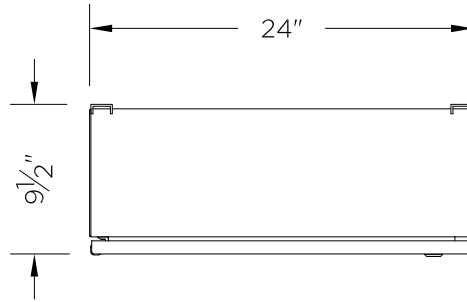

SELECT FLOW RATE:

- ☐ UP TO 200 GPM, 5HP
- ☐ UP TO 300 GPM, 5HP
- ☐ UP TO 400 GPM, 7.5HP
- ☐ UP TO 500 GPM, 10HP
- ☐ CUSTOM _____
- ☐ UV SYSTEM, OPTIONAL

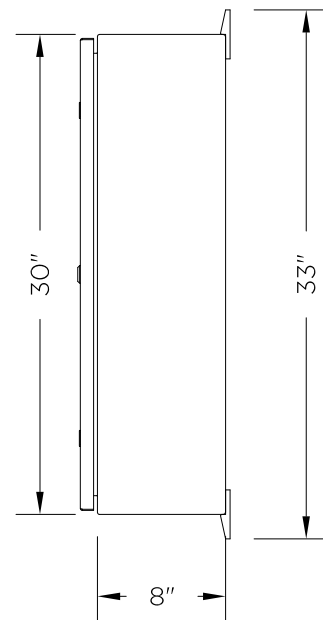
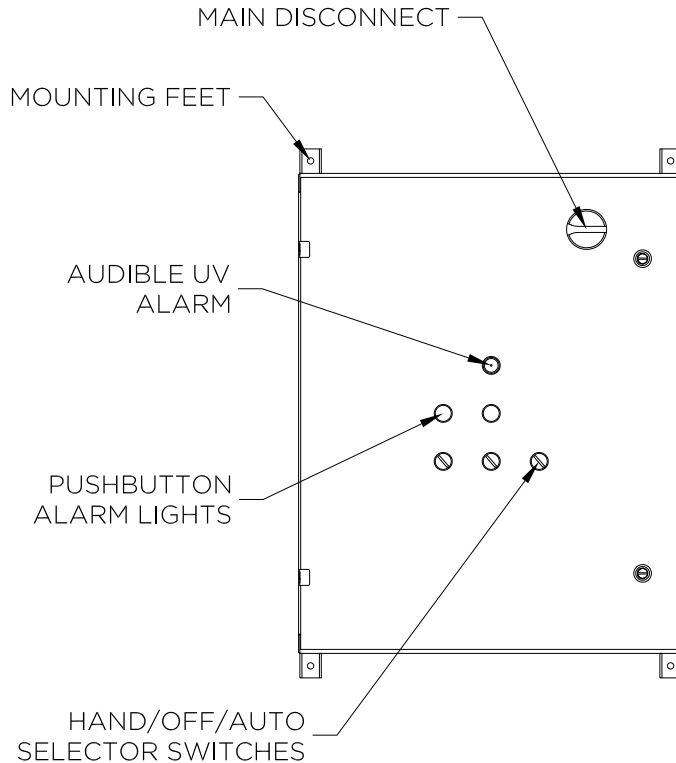

RECIRCULATION CONTROL PANEL NOTES:

- REQUIRED POWER: 230V/60A W/GFCI AND 110V, 15A W/GFCI (5HP)
230V/70A W/GFCI AND 110V, 15A W/GFCI (7.5HP)
230V/90A W/GFCI AND 110V, 15A W/GFCI (10HP)
- INPUT FOR A 2 WIRE, 24VDC ACTIVATION BOLLARD
- INCLUDES CONTROLS AND LOCK-OUTS FOR 3HP FILTRATION SYSTEM, CHEMICAL CONTROLLER AND DRAIN TO WASTE VALVE
- INCLUDES ADJUSTABLE TIMECLOCK FOR HOURS OF OPERATION AND TIMER FOR RUNTIME DURATION.
- POWDERCOATED, STEEL NEMA 4 ENCLOSURE
- CUSTOM PANEL SIZE AND VOLTAGE REQUIREMENTS T.B.D.



1101 McKinley Parkway
Delano, MN 55328
877-632-0503
Local 952-445-5135
aquatix.playlsi.com

RECIRCULATION CONTROL PANEL

P.J.B.
DRAWN BY

1"=1'-0"
SCALE

2/14/23
DATE

This drawing is issued in confidence for engineering information only. This drawing shall remain the property of Aquatix and may not be reproduced, disclosed to a third party, or used to manufacture anything without direct written permission from Aquatix. Unauthorized use shall entitle Aquatix to all damages caused by such user including preparation charges, lost profits, damage to reputation and attorney's fees.

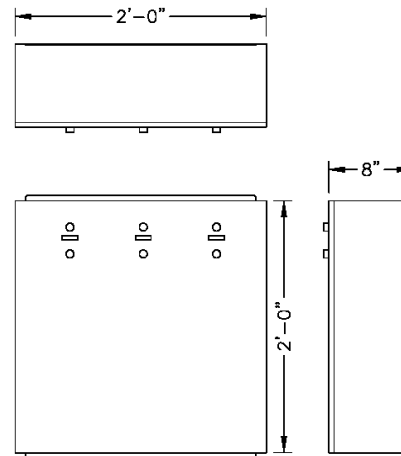

Control Panel

Control Panel to be UL listed and used to control simple on/off operations of water play activities or incorporate operation interface Programmable Logic Controller, (PLC), to create splash pad zoning or sequencing activities.

To be UL listed and may consist of:

- Pump(s) motor starters
- Time clock controls to set hours of operation and set duration time of activated devices
- VFD pump controls
- Flow switch controls
- Pressure transducer controls
- Power feeds to manifold distribution solenoid valves
- Activation Bollard relay switches
- Chemical treatment system power feed
- Vault internal electrical distribution
- Waste valve box relay & power feed
- Water heater relay
- All NEMA rated components
- NEMA 4 enclosure

*All control panels are designed for specific projects

Recirc Distribution Manifold Data:

Total Feature Flow Rate:	Project Specific
Optional Zoning Electrical Control Valves:	Yes / No
Optional Sequencing Electrical Control Valves:	Yes / No
Number of Manifold Discharge Lines:	_____

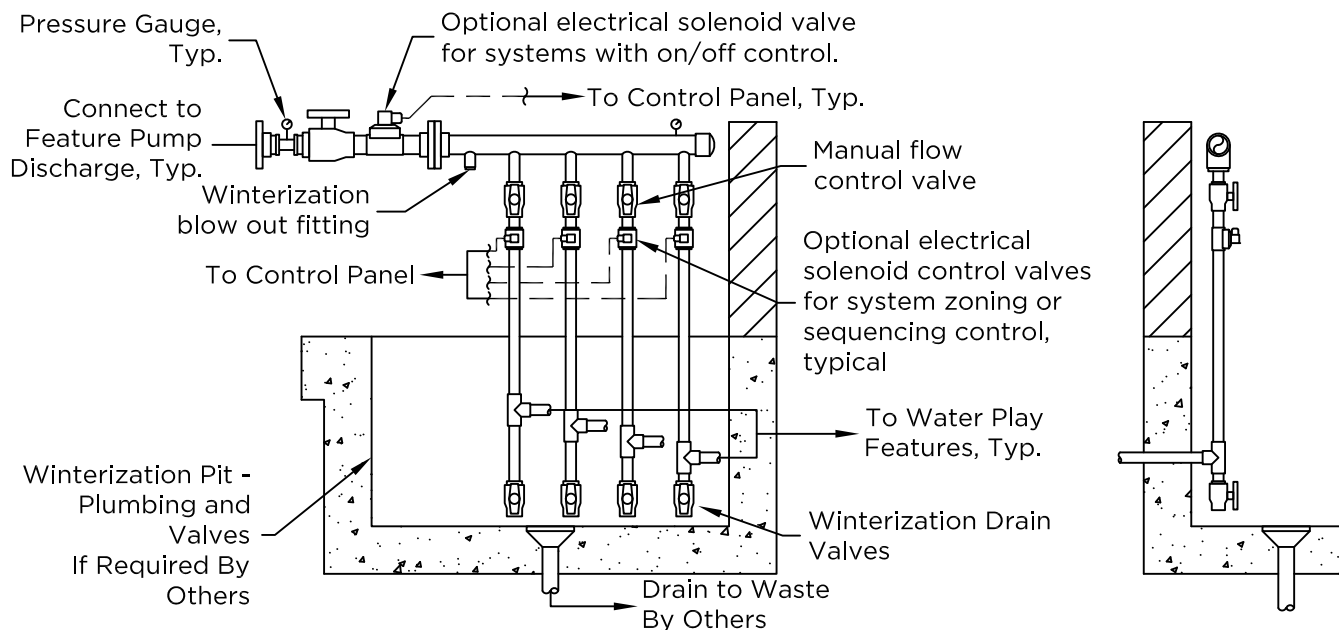

Jackson County Splash Pad SPECIFICATIONS APPENDIX 3

Note:

- Configuration of manifold to be project specific.
- All discharge lines are supplied with manual ball valves to regulate flow.
- If system is designed for zone or sequencing, electrical activation valves will be added and controlled by PLC in control panel.
- All plumbing lines and valving shall be installed per local codes and regulations.



1101 McKinley Parkway
Delano, MN 55328
877-632-0503
Local 952-445-5135
aquatix.playlsi.com

RECIRC DISTRIBUTION MANIFOLD

KML
DRAWN BY

3/4"=1'-0"
SCALE

9/21/16
DATE

This drawing is issued in confidence for engineering information only. This drawing shall remain the property of Aquatix and may not be reproduced, disclosed to a third party, or used to manufacture anything without direct written permission from Aquatix. Unauthorized use shall entitle Aquatix to all damages caused by such user including preparation charges, lost profits, damage to reputation and attorney's fees.

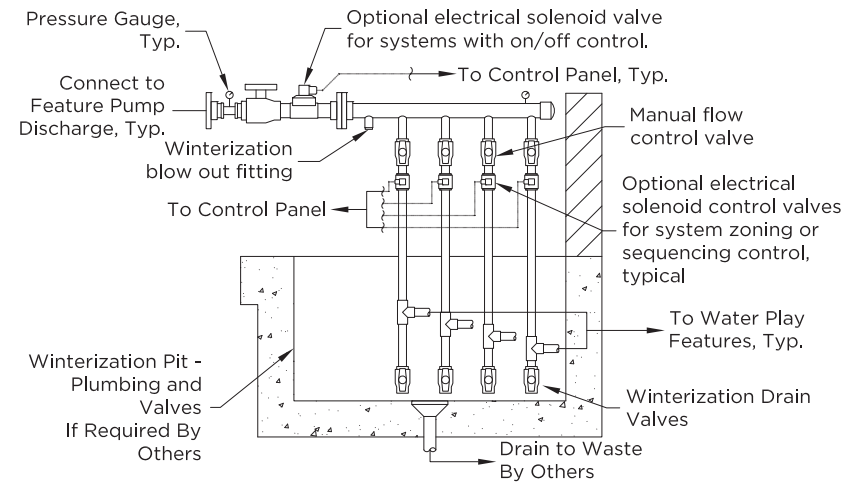

Recirculation Distribution Manifold

Distribution Manifolds are pre-plumbed water delivery systems from feature pumping system to water play features. Standard distribution manifolds consist of manual flow control valves that regulate water flow levels to each water element for on/off control systems. When creating water play zones or sequencing water play activities, standard distribution manifolds can be upgraded with electric valves or solenoid valves.

May Consist of:

- Schedule 80 Gas Welded PVC prefabricated manifold
- Manual flow control valves
- Electrical solenoid valves
- Winterization blow out
- Pressure gauge

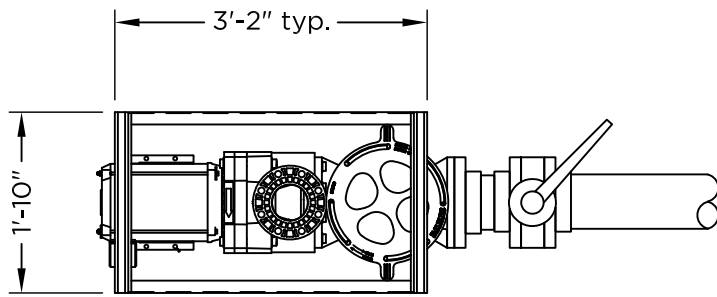

NOTE:
-ALL DIMENSIONS ARE APPROXIMATE AND WILL
NEED TO BE VERIFIED.

To Distribution Manifold
(See Seperate Product
Information)

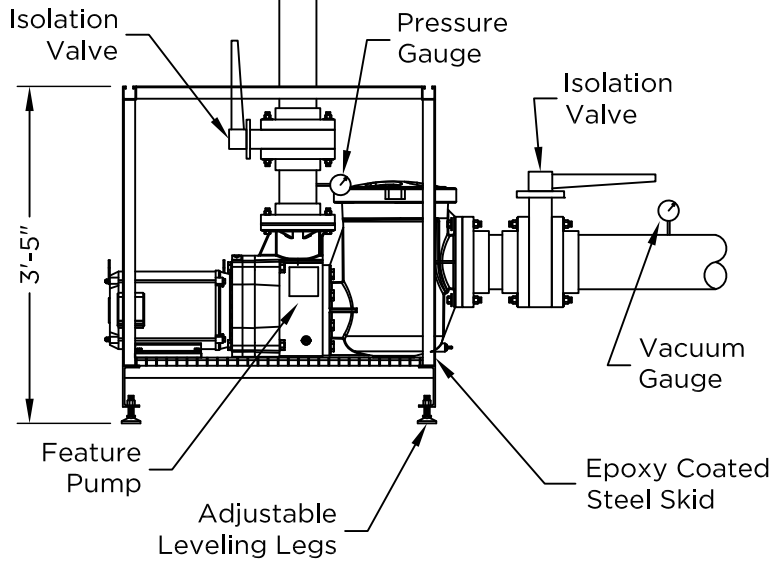

Jackson County Splash Pad SPECIFICATIONS APPENDIX 3

Feature Skid Sizing Chart: (Self-Priming Pump)

Flow Rate:	Horse Power
335 gpm	5 hp
465 gpm	7.5 hp
545 gpm	10 hp
765 gpm	15 hp

*All Flows Aat 40' TDH



877-632-0503
Local 952-445-5135
Fax 952-345-6444
aquatix.playlsi.com

SELF-PRIMING FEATURE PUMP SKID

KML
DRAWN BY

1/2"=1'-0"
SCALE

11/10/16
DATE

This drawing Is Issued In confidence for engineering information only. This drawing shall remain the property of Aquatix and may not be reproduced, disclosed to a third party, or used to manufacture anything without direct written permission from Aquatix. Unauthorized use shall entitle Aquatix to all damages caused by such user including preparation charges, lost profits, damage to reputation and attorney's fees.

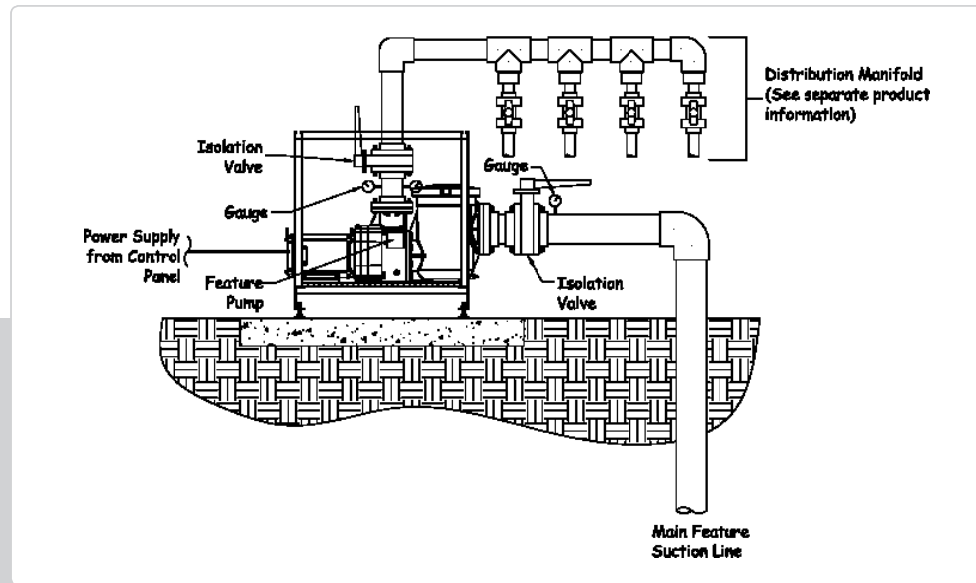

Feature Skid

Feature Skid to be UL listed system capable of flow rates from 250 gpm to 3000 gpm. System equipment to be pre plumbed using all schedule 80 PVC pipe & fittings and mounted on a epoxy painted steel skid with adjustable leveling legs. System to be tested prior to shipment.

May consist of:

- Self-Priming feature pump with hair and lint strainer.
- Pump suction check valve and isolation valve.
- Pump discharge isolation valve.
- Pump vacuum gauge
- Pump pressure gauge

Feature/Filtration Skid Cartridge:

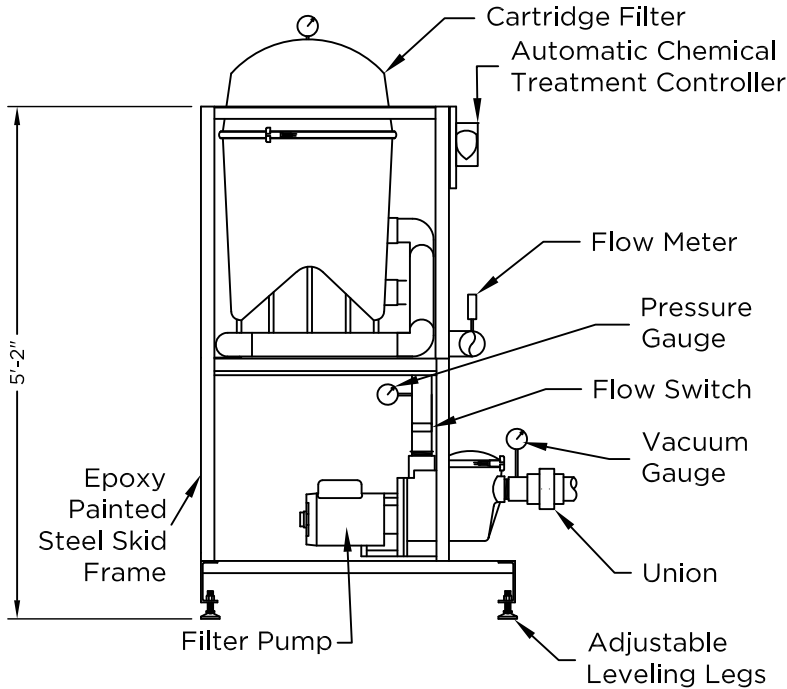
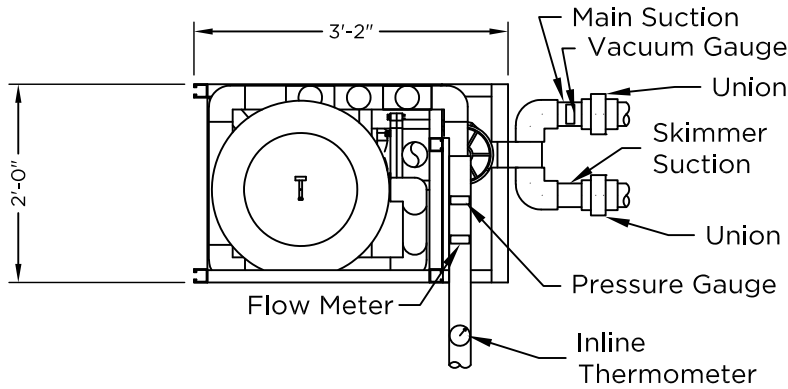

Filtration Flow Rate: 95 gpm
 (Minimum divide water capacity by a factor of 30) 105 gpm
 137 gpm

Turnover: 30 mins.
 (Minimum 30-minutes)

Main Power Supply:
 **See Control Panel Product Information.

Filter Suction Line Sizes: 2" skimmer
 3" main suct.

Filter Return Line Size: 4" inch

Note:
 -Above information is preliminary.
 Exact system requirements will need to be verified.

NOTE:
 -ALL DIMENSIONS ARE APPROXIMATE AND WILL NEED TO BE VERIFIED.
 -CONTROL PANEL CAN BE ATTACHED TO SKID OR AT A REMOTE LOCATION.

Jackson County Splash Pad SPECIFICATIONS APPENDIX 3

Filtration Skid Sizing Chart:

Filter Flow Rate:	Max. Feature Flow Rate:	Max. Water Reservoir Volume
95 gpm	500 gpm	2700 gallon
105 gpm	600 gpm	3000 gallon
137 gpm	800 gpm	4000 gallon

(Above information are minimum guidelines. Specific project splash pad filtration rates should be designed based on site conditions, source water quality, anticipated patron usage, environmental conditions, and hours of operation. Systems are designed for continuous operation, (24-hour, 7-days a week). All system designs should be based on local and state health department regulations.)



877-632-0503
 Local 952-445-5135
 Fax 952-345-6444
 aquatix.playlsi.com

FILTRATION SKID CARTRIDGE

KML
DRAWN BY

1/2"=1'-0"
SCALE

9/21/16
DATE

This drawing is issued in confidence for engineering information only. This drawing shall remain the property of Aquatix and may not be reproduced, disclosed to a third party, or used to manufacture anything without direct written permission from Aquatix. Unauthorized use shall entitle Aquatix to all damages caused by such user including preparation charges, lost profits, damage to reputation and attorney's fees.



Filtration Skid to be UL listed system capable of filtration rates from 50 gpm to 300 gpm. Filtration Systems flow rate should be based on a minimum of 30 minute turnover rate. System equipment to be pre-plumbed using all schedule 80 PVC pipe & fittings, pre-wired and mounted on an epoxy painted steel skid with adjustable leveling legs. Skid system to have main motor control panel that will operate filtration pump, feature pump, water fill system, chemical treatment system, and collector box drain to waste valve. System to be tested prior to shipment.

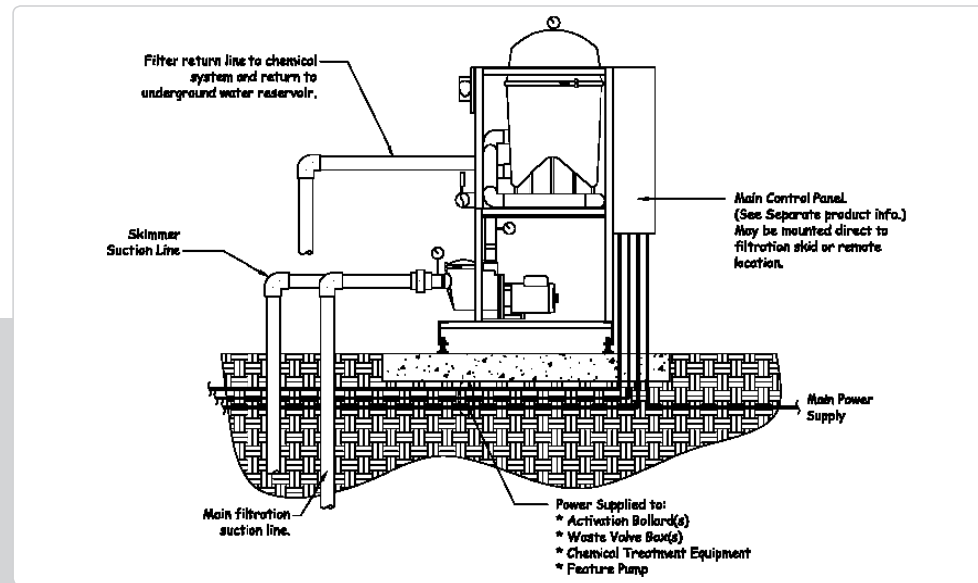

Filtration Skid

System may consist of the following components:

- Epoxy painted steel skid with adjustable leveling legs.
- Self priming filtration pump with integral hair and lint strainer.
- Sand or Cartridge filter with pressure gauge and pressures/air relief valve.
- Main system panel with GFCI breakers, time clocks, and needed relays.
- Automatic chemical controller for monitoring and adjustment of Chlorine & pH.
- Inline Pilot type flow meter.
- Pump vacuum Gauge
- Pump pressure Gauge
- Flow Switch

*Specific project splash pad filtration rates should be designed based on site conditions, source water quality, anticipated patron usage, environmental conditions, and hours of operation. Systems are designed for continuous operation, (24-hour, 7-days a week). All system designs should be based on local and State Health Department Regulations.

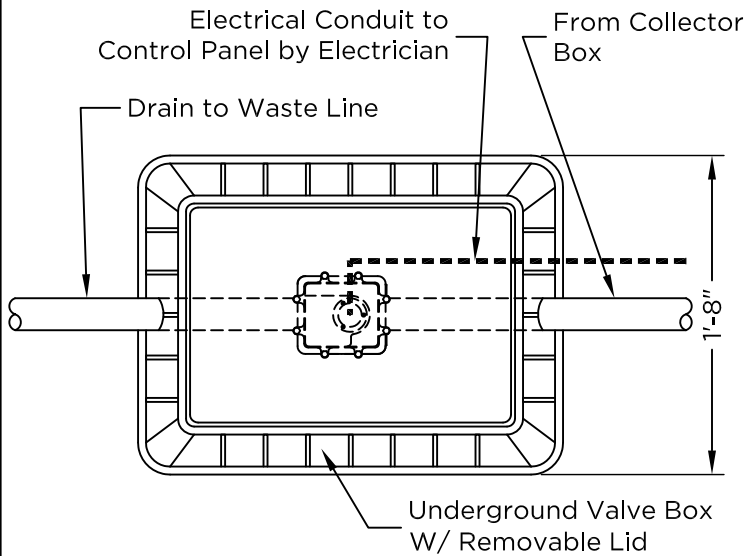

Waste Valve Box:

Splash Pad Area: _____

1" per/hour Rain Fall Flow: _____ (gpm)
(Approx. 1,000 s.f. area = 10 gpm flow rate)

Size Line of Waste Valve Box: _____

Number of Waste Valve Box (es): _____

Note: Above information is preliminary. Exact number of waste valve boxes needed for splash pad design based on maximum of 1" rain fall per hour over the entire splash pad drainage area, and elevation / distance of waste line to outlet.

NOTE:

-ALL DIMENSIONS ARE APPROXIMATE & WILL NEED TO BE VERIFIED.

Jackson County Splash Pad SPECIFICATIONS APPENDIX 3

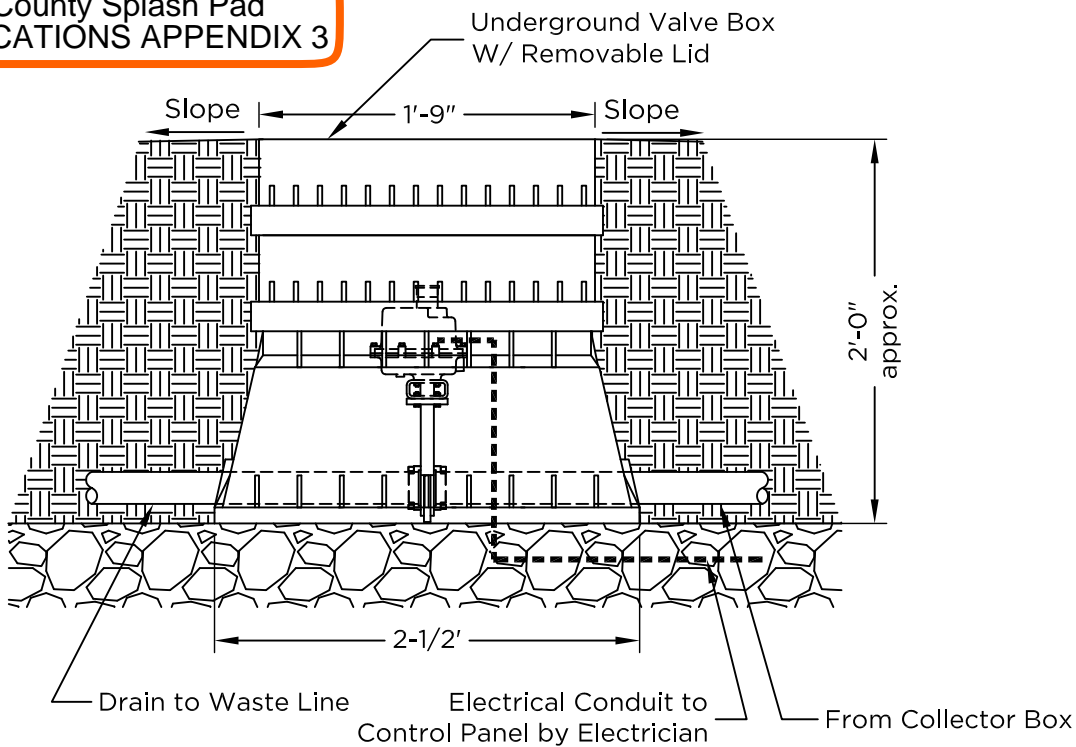

Waste Valve Box Sizing Chart:

Selection	Qty.	Model No.	Max. Gravity Flow Rate: (per box)	Line Size:
<input type="checkbox"/>	()	WVB-200	35 gpm	() 2" Lines
<input type="checkbox"/>	()	WVB-300	65 gpm	() 3" Lines

Note: Maximum drainage is based on a 1/4" per foot slope from collector box connection to waste valve drainage line outlet.

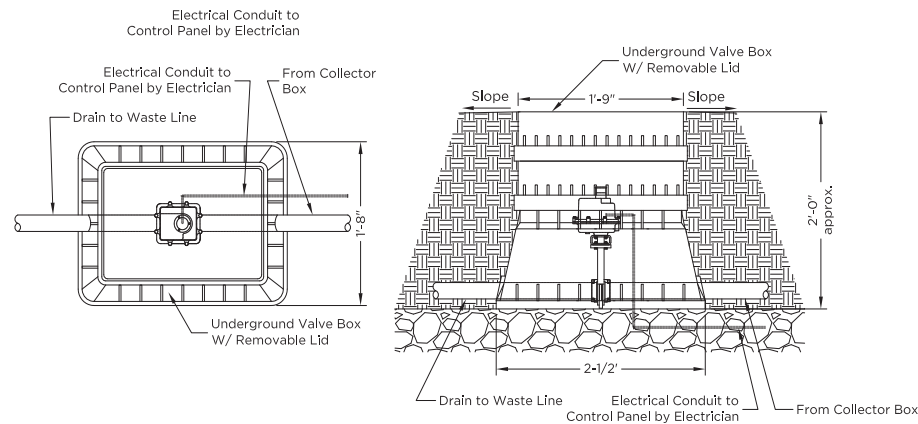

Rain Diverting Waste Valve Box

The **Rain Diverting Waste Valve Box** is an electrical solenoid valve housed in a 100% recycled HDPE burial box that allows the collector box(s) to drain all water to waste when system is not in operation. Water to be evacuated through underground waste line from collector box through waste valve box to either site drainage area or waste. Waste valve box minimizes the potential for contamination of underground reservoir. Waste valve box size & quantity to be based on evacuating 1 inch rain fall per hour over entire splash pad drainage area.

May consist of:

- Structural foam HDPE resin that is resistant to UV light, weather, moisture and chemical action of soils
- Burial box with removable lid
- Motorized rain diverting valve
- (2) Drain line connection ports

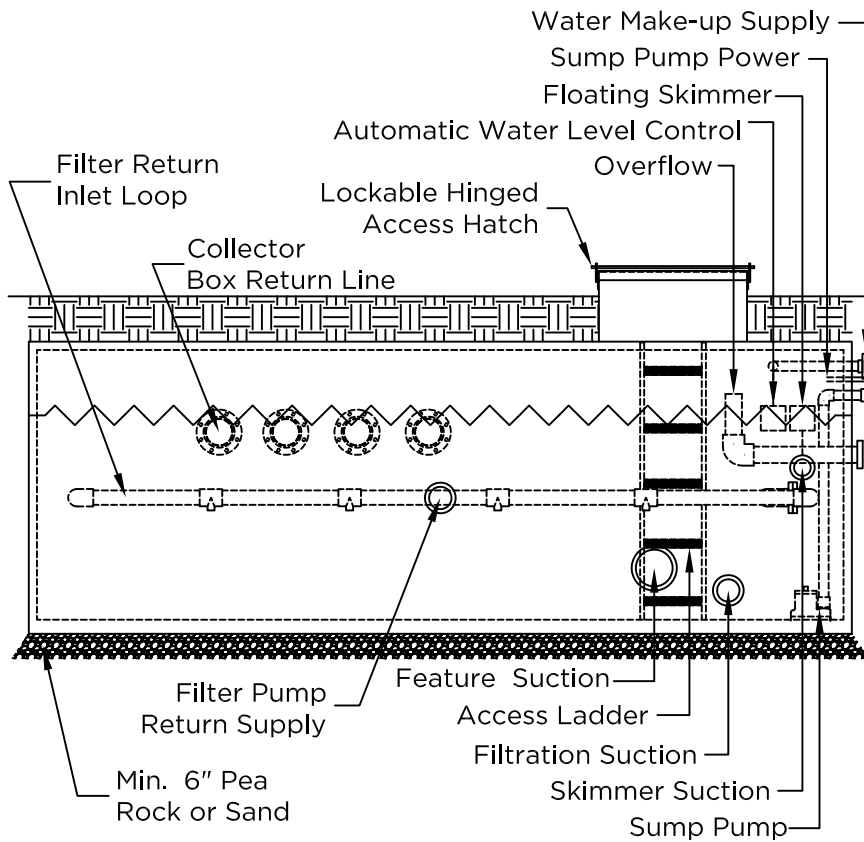

Water Reservoir Tank Data:

Number of 6" Collector Box Lines: _____

Standard Water Make-up Supply Line Size: _____ 1"

Standard Overflow / Waste Line Size: _____ 3"

Note: Above information is preliminary. Exact system requirements will need to be verified...

Note:
-Drawings are not to scale.

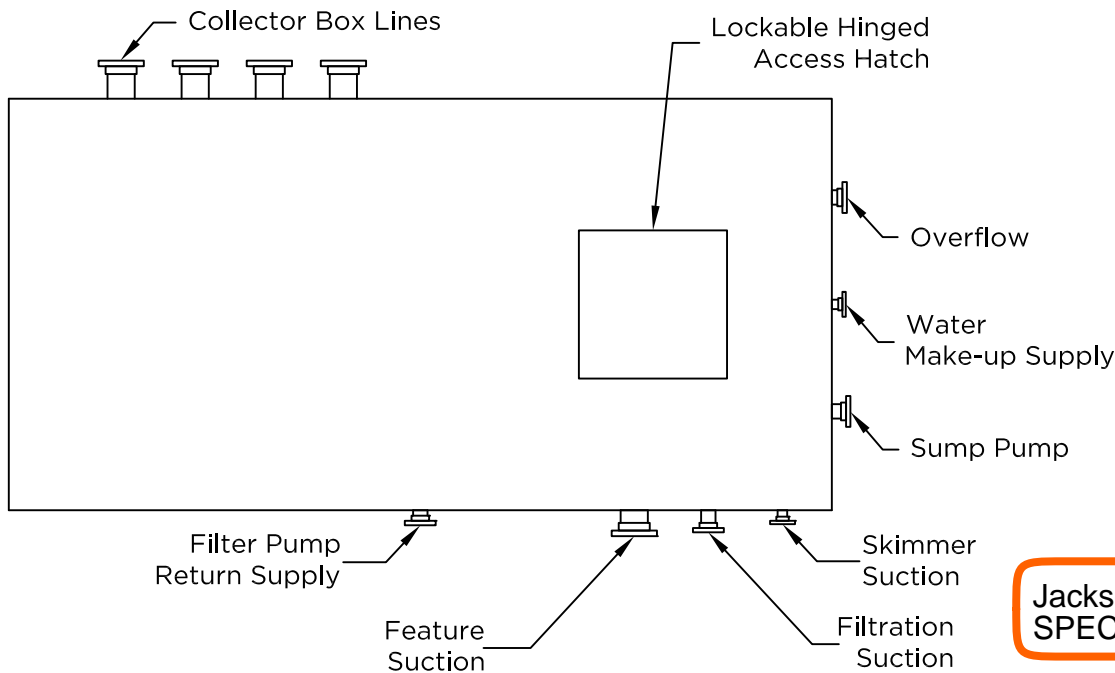

**Jackson County Splash Pad
SPECIFICATIONS APPENDIX 3**

Water Reservoir Tank Sizing Chart:

<u>Working Capacity</u>	<u>Max. Feature Flow Rate: (per tank)</u>	<u>Weight of Lid/Tank:</u>
2700 gal.	600 gpm	Lid: 6,000 & Tank: 13,000 - 19,000 lbs Total
3000 gal.	800 gpm	Lid: 14,000 & Tank: 18,000 - 32,000 lbs Total
5000 gal.	800 gpm	Two Halves: 19,000 ea - 38,000 lbs Total

Jackson County Splash Pad SPECIFICATIONS APPENDIX 4



The play components identified on this plan are iPEMA certified. (Unless model number is preceded with *) The use and layout of these components conform to the requirements of ASTM F1487. To verify product certification, visit www.ipema.org

THIS PLAY AREA & PLAY EQUIPMENT IS
DESIGNED FOR AGES **5-12 YEARS**
UNLESS OTHERWISE NOTED ON PLAN.

IT IS THE MANUFACTURER'S OPINION THAT THIS PLAY AREA DOES CONFORM TO THE A.D.A. ACCESSIBILITY STANDARDS, ASSUMING AN ACCESSIBLE PROTECTIVE SURFACING IS PROVIDED, AS INDICATED, OR WITHIN THE ENTIRE USE ZONE.

THIS CONCEPTUAL PLAN WAS BASED ON INFORMATION AVAILABLE TO US, PRIOR TO CONSTRUCTION. DETAILED SITE INFORMATION INCLUDING SITE DIMENSIONS, TOPOGRAPHY, EXISTING UTILITIES, SOIL CONDITIONS, AND DRAINAGE SOLUTIONS SHOULD BE OBTAINED, EVALUATED, & UTILIZED IN THE FINAL DESIGN. PLEASE VERIFY ALL DIMENSIONS OF PLAY AREA, SIZE, ORIENTATION, AND LOCATION OF ALL EXISTING UTILITIES, EQUIPMENT, AND SITE FURNISHINGS PRIOR TO ORDERING. SLIDES SHOULD NOT FACE THE HOT AFTERNOON SUN.

CHOOSE A PROTECTIVE SURFACING MATERIAL THAT HAS A CRITICAL HEIGHT VALUE TO MEET THE MAXIMUM FALL HEIGHT FOR THE EQUIPMENT (REF. ASTM F1487 STANDARD CONSUMER SAFETY PERFORMANCE SPECIFICATION FOR PLAYGROUND EQUIPMENT FOR PUBLIC USE, SECTION 8 CURRENT REVISION). THE SURFSURFACE MUST BE WELL DRAINED, IF THE SOIL DOES NOT DRAIN NATURALLY IT MUST BE TILED OR SLOPED 1/8" TO 1/4" PER FOOT TO A STORM SEWER OR A "FRENCH DRAIN".

IL

COPYRIGHT: 10/6/23

3/6/23	1171481-01-04	IL
2/6/23	1171481-01-03	IL
1/27/23	1171481-01-02	IL
Date	Previous Drawing #	Initials

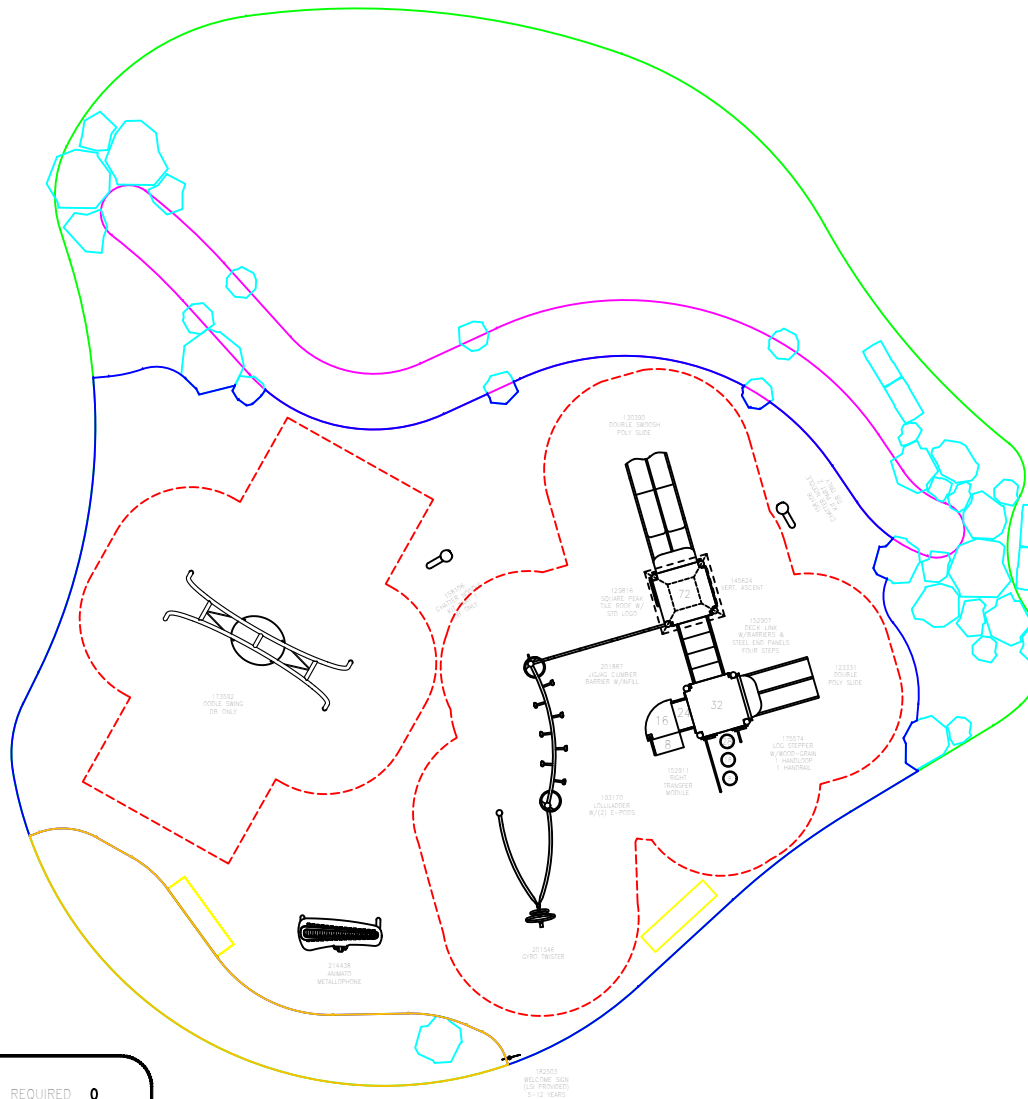

PlayBooster®
(5-12 years)
Max Fall Height: 90 inches

TOTAL ELEVATED PLAY COMPONENTS	5		
TOTAL ELEVATED COMPONENTS ACCESSIBLE BY RAMP	0	<u>REQUIRED</u>	0
TOTAL ELEVATED COMPONENTS ACCESSIBLE BY TRANSFER	5	<u>REQUIRED</u>	3
TOTAL ACCESSIBLE GROUND LEVEL COMPONENTS SHOWN	4	<u>REQUIRED</u>	2
TOTAL DIFFERENT TYPES OF GROUND LEVEL COMPONENTS	4	<u>REQUIRED</u>	4



Cashiers Playground

Cashiers, NC

Carolina Parks
and Play, LLC
Chris Yang

SYSTEM TYPE:
PlayBooster

DRAWING #:

1171481-01-05





Jackson County Splash Pad
SPECIFICATIONS APPENDIX 4



Cashiers Playground

1171481-01-04-01 • 03.06.2023





Jackson County Splash Pad
SPECIFICATIONS APPENDIX 4



Cashiers Playground

1171481-01-04-03 • 03.06.2023



©2023 Landscape Structures. All Rights Reserved.